

# AQUA ARC

BY BNW DEVELOPMENTS

AL MARJAN ISLAND









# 设计理念

## 建筑师寄语

受Ras Al Khaimah令人叹为观止的景观以及雄伟的Jais Mountain的启发,建筑概念模仿了自然山峰与山谷的有机形态,巧妙地将两个相互连接的街区融为一体,打造一个宁静如谷的绿洲。建筑顶部类似山洞设计,拥有迷人的开口,便于设置瀑布水景和户外休闲活动。阳台设计映射出海浪起伏的节奏,将山峦的壮丽与大海的魅力完美融合。每栋建筑都设有一个双层高的大堂,与繁茂的景观无缝融合,营造出和谐宁静的氛围。顶层豪华公寓提供360度全景视野,彰显著华巅峰。



# 您的终极奢华之选

奢华度假胜地

在位于拉斯海玛新兴且充满活力的Al Marjan Island中心的Aqua Arc体验极致奢华。Aqua Arc是一座独一无二的、以水为灵感打造的建筑杰作，它重新定义了奢华生活和终极休闲方式，让您在宁静的景观和湛蓝的水域中享受无与伦比的体验。

这座精致的居所堪称完美设计的典范，旨在提升您的生活方式，确保您踏上一段通往永恒优雅与精致的非凡旅程。











# 宁静的绿洲

期待您的到来

在Al Marjan Island的Aqua Arc开启一段海滨幸福与现代奢华相遇的旅程。在这里，现代精致与宁静的海洋旋律相得益彰。清晨醒来，听着海浪轻拍海岸，在您专属的阳台圣殿中欣赏湛蓝的全景。探索最精致的海滨生活，每一个细节都彰显着优雅与宁静，为您带来精致的生活方式体验。



海滩通道



步行小径



烧烤区









奢华生活的巅峰









# 无与伦比

## 优雅

Aqua Arc是一个奢华与宁静交融的圣地, 每一个细节都精心打造, 独具匠心。受海洋永恒魅力的启发, 住宅拥有令人惊叹的波浪形阳台, 映射出海岸生活的优雅。高端公寓在宽敞的露台上设有精心设计的私人泳池, 为住户提供了享有蔚蓝水域开阔视野的专属休憩之地。Aqua Arc重新定义了海滨生活的艺术, 在这里的每一刻都是对至臻奢华的颂歌。



海景



圆形露天剧场



露台泳池\*









梦想的栖息之所



① Al Marjan Island 海滩通道

② Al Marjan Island 大道

③ Al Marjan Island 度假酒店及水疗中心

④ Al Hamra 购物中心

⑤ Al Hamra 高尔夫俱乐部

⑥ Saudi German 医院

⑦ Wynn 度假村

⑧ Rixos Bab-al-Bahr 度假酒店

⑨ 希尔顿欢朋酒店

⑩ 希尔顿逸林度假酒店及水疗中心

⑪ Radisson 度假酒店

⑫ Mövenpick 度假酒店







## 精雕细琢打 造的圣地

在Aqua Arc体验海滨生活的巅峰,这是一处无与伦比的杰作,将海滨生活的宁静与城市精致的活力相融合,在阿联酋充满活力的分外中创造出一片宁静的绿洲。凭借其得天独厚的地理位置和对细节的极致关注,Aqua Arc提供了一个难得的机会,让您在世界上最令人向往的目的地之一,拥抱极致奢华的生活方式。



铂金健身房



儿童戏水池



蒸汽房和桑拿房









一流的设施









## 精致 典雅

这些非凡住宅的每一个元素都经过精心策划,以确保永恒品质与现代魅力的完美融合。从您踏入的那一刻起,迎接您的是无可挑剔的工艺、奢华的装饰和宽敞的布局,其设计超越了最挑剔的标准。沉浸在一个无与伦比的精致与舒适的世界中,每一个细节都经过深思熟虑,以提升您的居住体验。



全景视野



极致奢华生活



注重细节







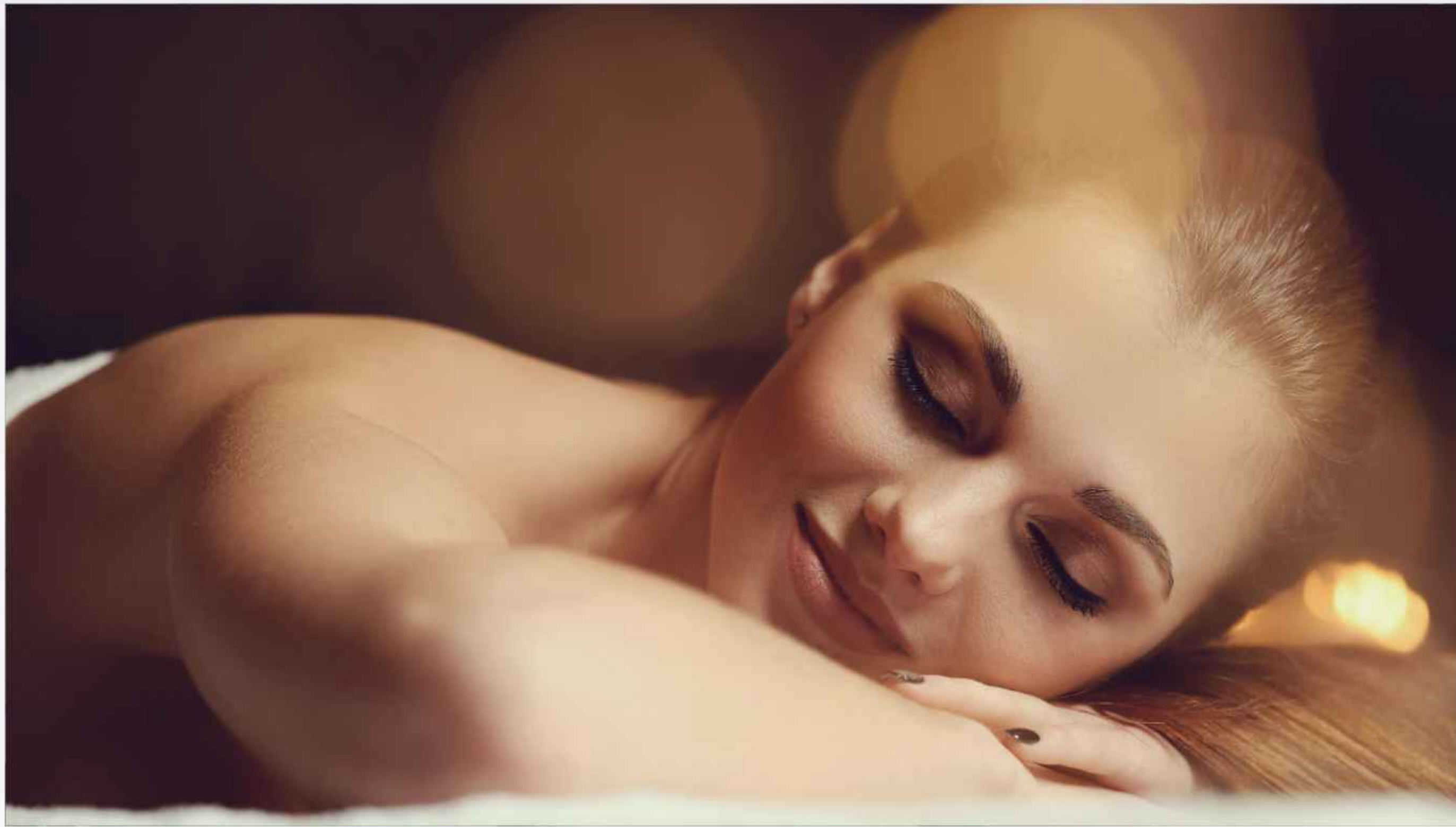

奢华享受, 尽情释放





## 通往奢华之门

Aqua Arc项目是Ras Al Khaimah的 Al Marjan Island宁静海岸边精致奢华的典范。从流畅的建筑线条到定制设施,每一个细节都精心打造,散发着无与伦比的精致与奢华。以拉斯海玛原始海岸线的壮丽景色为背景, Aqua Arc宛如一座永恒的优雅的灯塔,邀请宾客沉浸在一个奢华无界的世界中。



屋顶泳池



休闲区



奢华景观





## ANKUR AGGARWAL

董事长兼创始人

Ankur Aggarwal是一名特许会计师,也是 BNW地产公司的远见卓识的创始人。他凭借其在拉斯海玛和迪拜等黄金地段的著名综合用途项目,迅速将公司定位为豪华房地产领域的领导者。其资产管理规模(AUM)超过150 亿迪拉姆,这些项目展示了安库尔对卓越和创新的不懈追求。每个开发项目都都将尖端设计与卓越品质以及非凡奢华完美融合,为行业树立了新的标杆。



## VIVEK ANAND OBEROI

总经理兼联合创始人

Vivek Anand Oberoi是 BNW 的总经理兼联合创始人,因其在印度电影、创业和慈善事业中的多面手生涯而备受赞誉。他出演过47部涵盖七种语言的电影,并凭借《内幕边缘》(Inside Edge)获得艾美奖提名。福布斯将他评为全球前40位慈善家之一,他将利他主义融入商业战略。通过他的家族办公室,他管理着多家公司,确保这些公司遵循道德和可持续的原则。



# 户型平面图



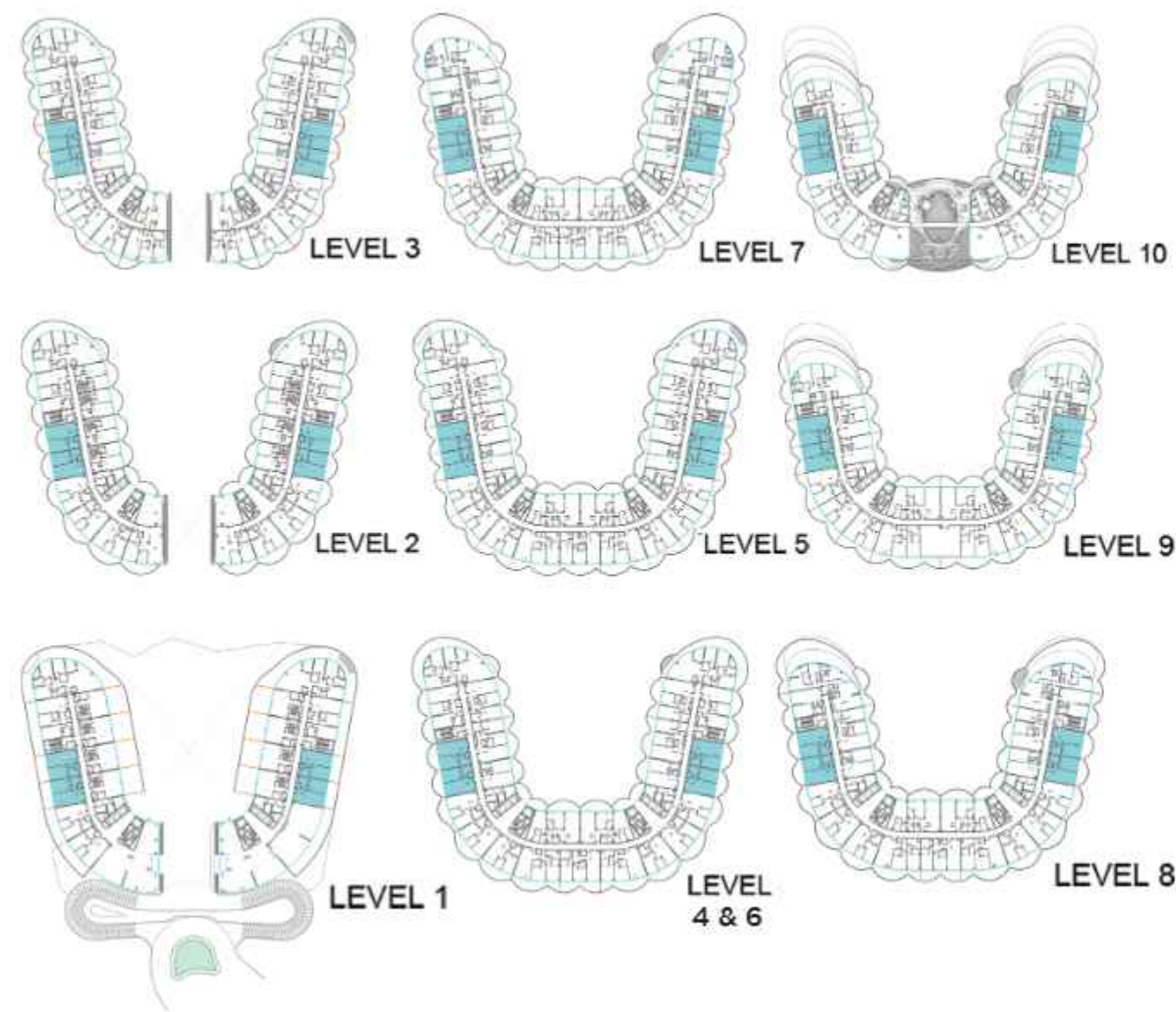

# 1 BEDROOM

## TYPE A

1	KITCHEN	3m x 2.9m
2	LIVING	6.6m x 4.0m
3	BALCONY	MIN. 1m wide
4	BEDROOM	3.8m x 5.4m
5	BATH	2.9m x 2.9m
6	PWD ROOM	1.8m x 1.8m
7	LAUNDRY	0.9m x 1.6m

	From	To
Suite Area	850.78sq. ft.	861.22sq. ft.
Balcony Area	241.33 sq. ft.	310.11 sq. ft.
Total Area	1092.11 sq. ft.	1171.33 sq. ft.

\*All images used for illustrative purposes only and do not represent the actual size, feature specifications, fitting, and furnishing. The developer reserves the right to make revision / alterations, at its absolute discretion, without any liability whatsoever.



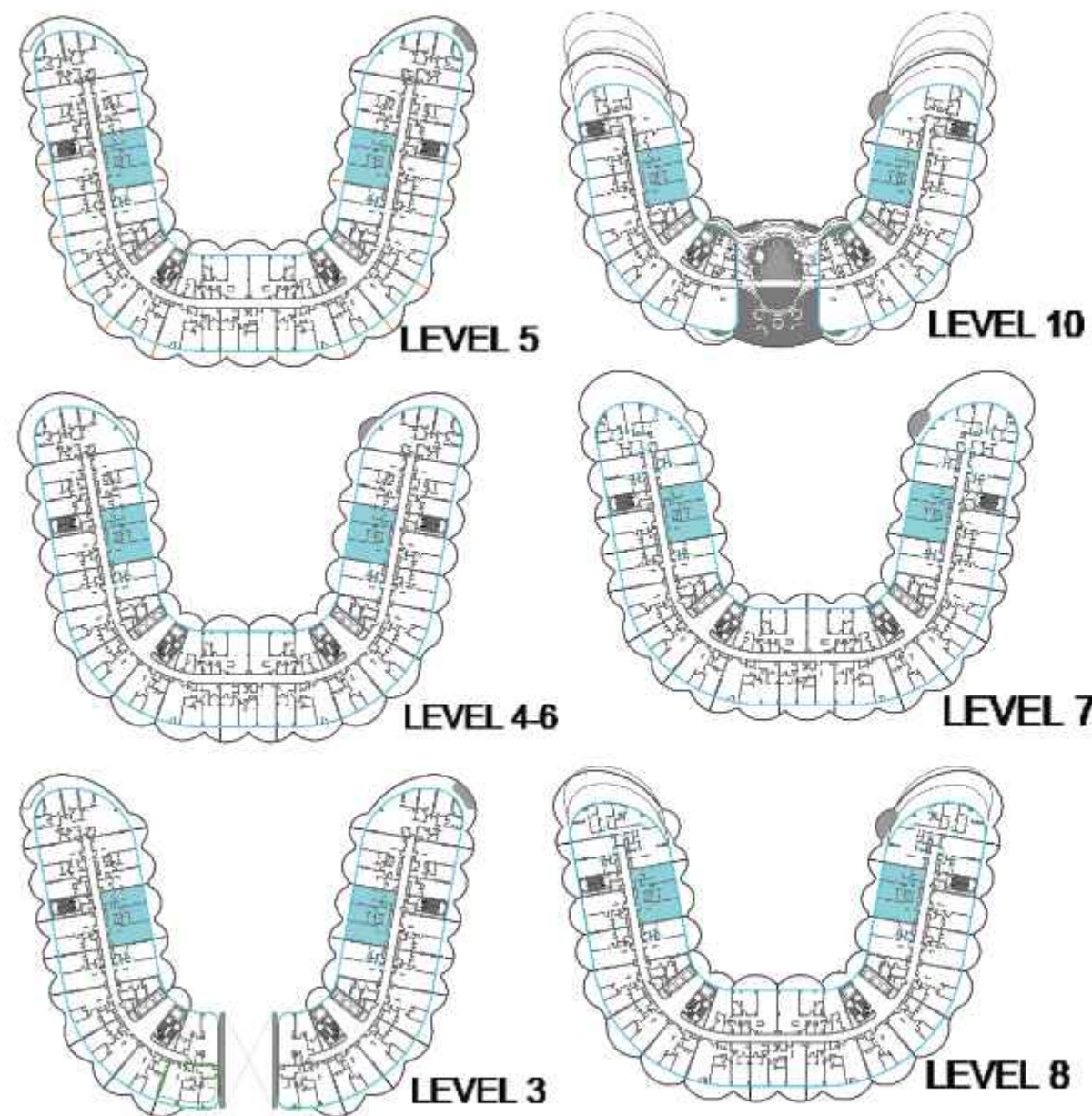

# 2 BEDROOM

## TYPE C

1	KITCHEN	2.9m x 3.1m
2	LIVING	4.3m x 6.5m
3	BALCONY	MIN 1.6m wide
4	BEDROOM	4.2m x 3.5m
5	BATH	2.6m x 1.6m
6	BEDROOM	3.8m x 4.7m
7	BATH	2.5m x 2.9m
8	PWD ROOM	1.9m x 0.9m
9	LAUNDRY	1.2m x 1.1m

	From	To
Suite Area	1267.34 sq. ft.	1281.34sq. ft.
Balcony Area	343.48 sq. ft.	350.47sq. ft.
Total Area	1610.82sq. ft.	1631.81sq. ft.



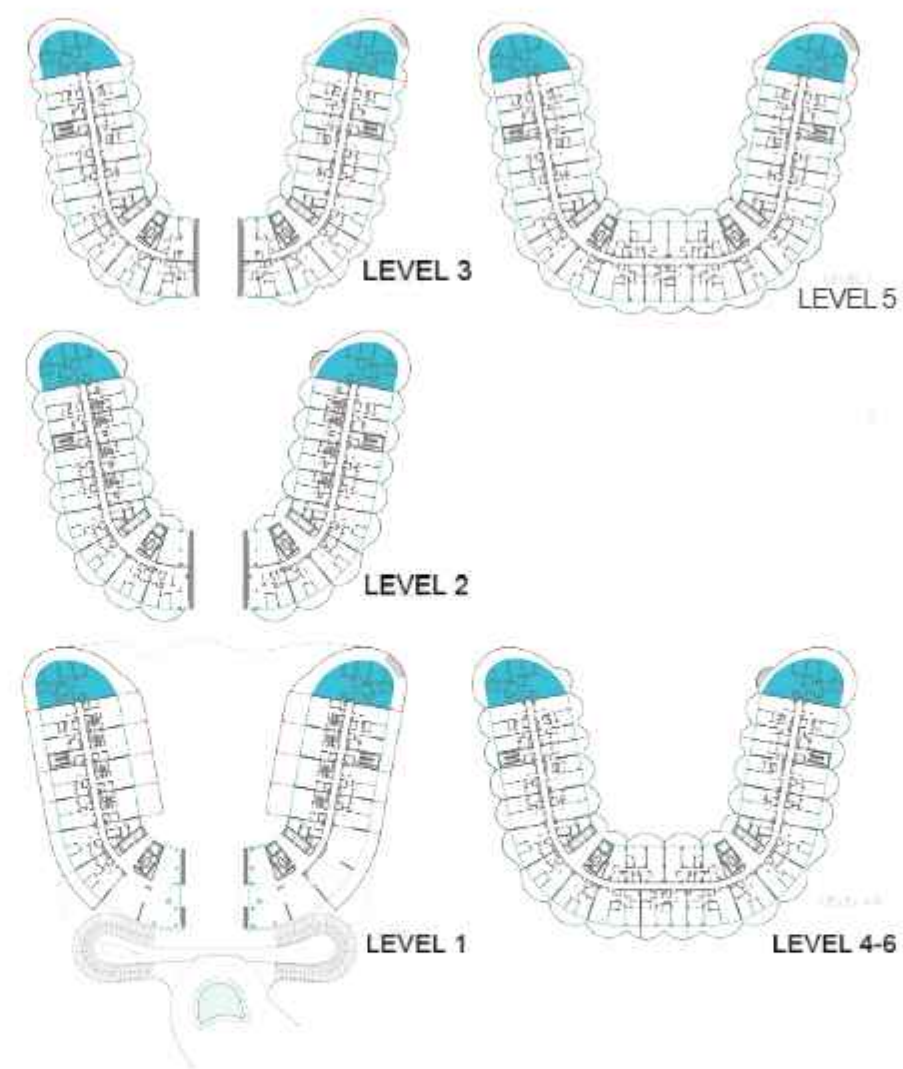

	From	To
Suite Area	2135.02 sq. ft.	2135.56 sq. ft.
Balcony Area	1140.87 sq. ft.	1644.19 sq. ft.
Total Area	3275.89 sq. ft.	3779.75 sq. ft.

# 3 BEDROOM

## TYPE A

1	KITCHEN	3.6m x 2.5m
2	LIVING	8m x 9.5m
3	BALCONY	MIN.1.2m wide
4	STUDY	3.5m x 4.2m
5	BEDROOM	3.4m x 4.2m
6	BATH	2.2m x 2.7m
7	PWD ROOM	1.6m x 2.1m
8	BEDROOM	3.7m x 3.7m
9	BATH	2.6m x 3.0m
10	BATH	2.5m x 3.4m
11	BEDROOM	5.0m x 3.9m
12	STORE	2.4m x 2.8m
13	LAUNDRY	1.1m x 0.9m
14	BATH	1.9m x 1.6m
15	PRIVATE POOL	





	From	To
Suite Area	2081.09 sq. ft.	2082.31 sq. ft.
Balcony Area	2353.53 sq. ft.	2353.31 sq. ft.
Total Area	4434.62 sq. ft.	4434.62 sq. ft.

# 3 BEDROOM

## TYPE C

1	KITCHEN	4.2m x 2.4m
2	DINING	4.7m x 3.9m
3	LIVING	6m x 4m
4	LAUNDRY	1.2m x 1m
5	PWD ROOM	2.3m x 1.5m
6	BEDROOM	6.7m x 4.4m
7	BATH	1.2m x 2.5m
8	BATH	3.6m x 2.9m
9	BEDROOM	3.5m x 3.1m
10	BATH	1.6m x 2.9m
11	BEDROOM	4.7m x 7.2m
12	BATH	2m x 3.9m
13	STORE	1.7m x 2.5m
14	BALCONY	MIN. 1.54m wide
15	PRIVATE POOL	





# PENTHOUSE

1	KITCHEN	6.3m x 5.2m	10	BEDROOM	4.05m x 6.7m
2	LIVING	16.3m x 7.4m	11	BATH	2.4m x 2.7m
3	PWD ROOM	1.6m x 1.2m	12	BEDROOM	10.1m x 6m
4	BATH	2.8m x 1.5m	13	BATH	3.4m x 5.3m
5	STUDY	3.6m x 5.3m	14	BEDROOM	5.4m x 4.2m
6	BEDROOM	4.2m x 3.1m	15	BATH	2.5m x 3.4m
7	BATH	2.3m x 2.3m	16	BALCONY	MIN. 1.2m wide
8	BEDROOM	4m x 6m	17	LAUNDRY	1m x 1.2m
9	BATH	3m x 2.4m	18	PRIVATE POOL	

	From	To
Suite Area	5547.72 sq. ft.	5549.44sq. ft.
Balcony Area	3111.42 sq. ft.	3111.52 sq. ft.
Total Area	8659.14 sq. ft.	8660.97 sq. ft.



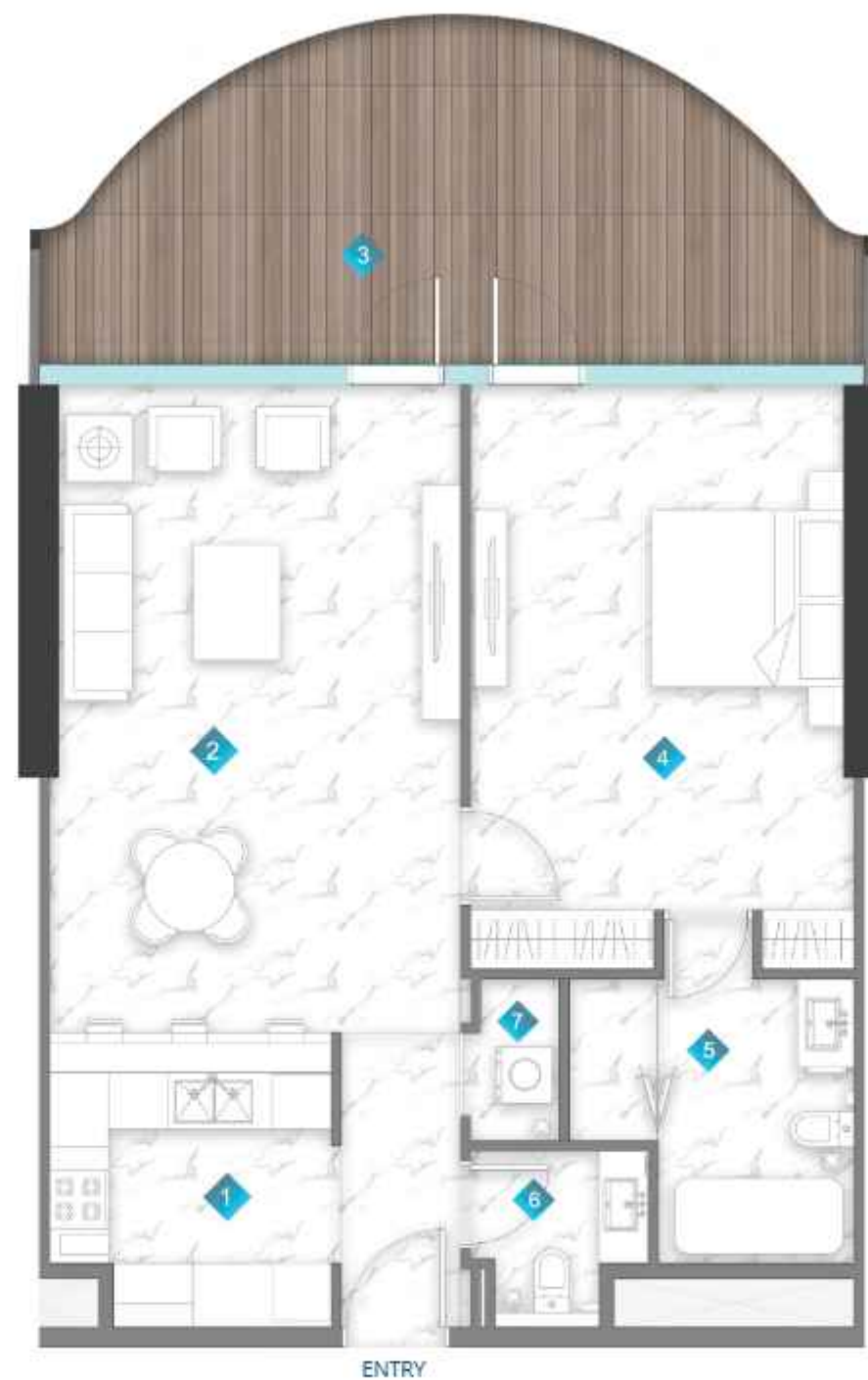
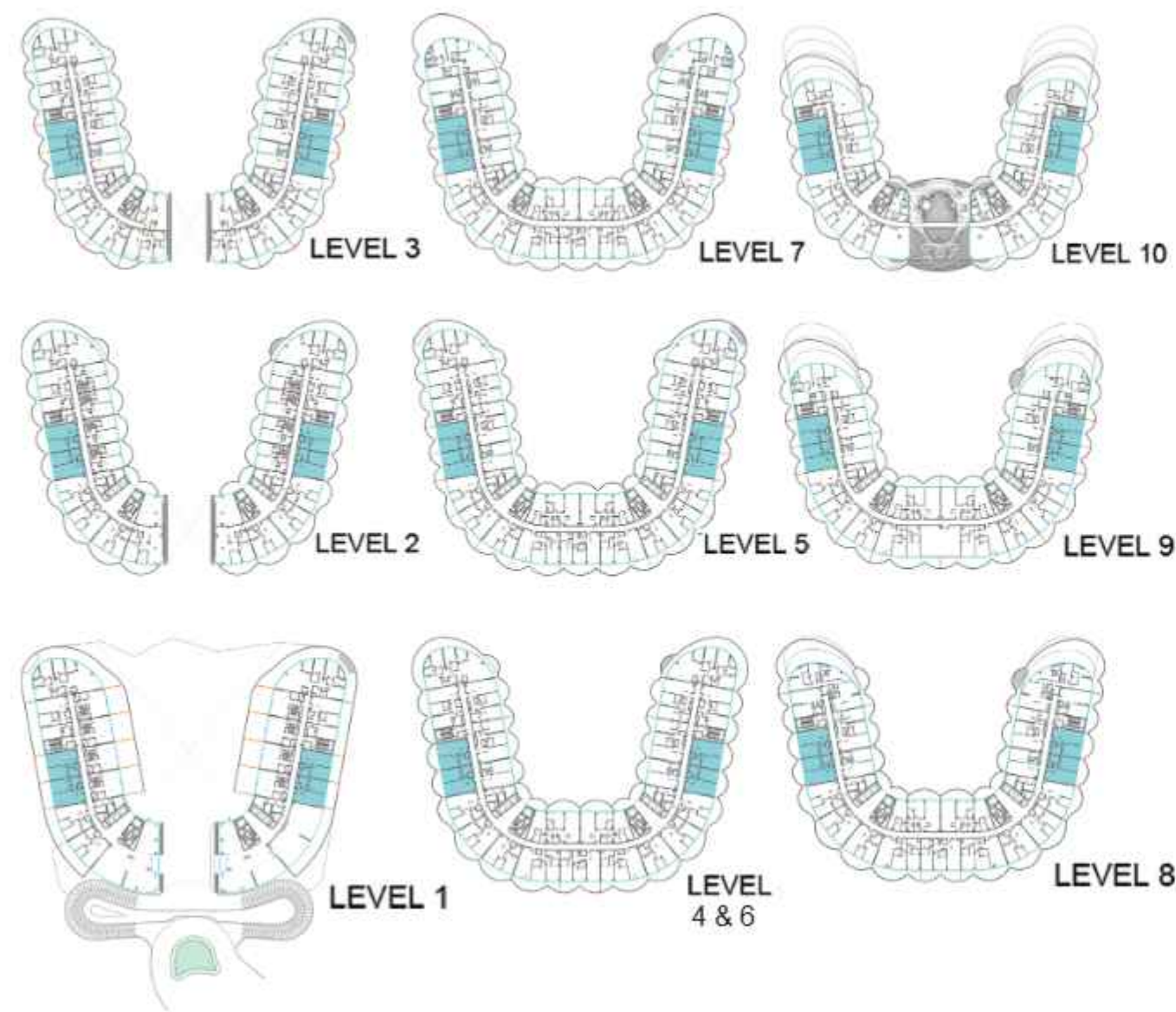

# 1 BEDROOM

## TYPE A

1	KITCHEN	3m x 2.9m
2	LIVING	6.6m x 4.0m
3	BALCONY	MIN. 1m wide
4	BEDROOM	3.8m x 5.4m
5	BATH	2.9m x 2.9m
6	PWD ROOM	1.8m x 1.8m
7	LAUNDRY	0.9m x 1.6m

	From	To
Suite Area	850.78sq. ft.	861.22sq. ft.
Balcony Area	241.33 sq. ft.	310.11 sq. ft.
Total Area	1092.11 sq. ft.	1171.33 sq. ft.

\*All images used for illustrative purposes only and do not represent the actual size, feature specifications, fitting, and furnishing. The developer reserves the right to make revision / alterations, at its absolute discretion, without any liability whatsoever.



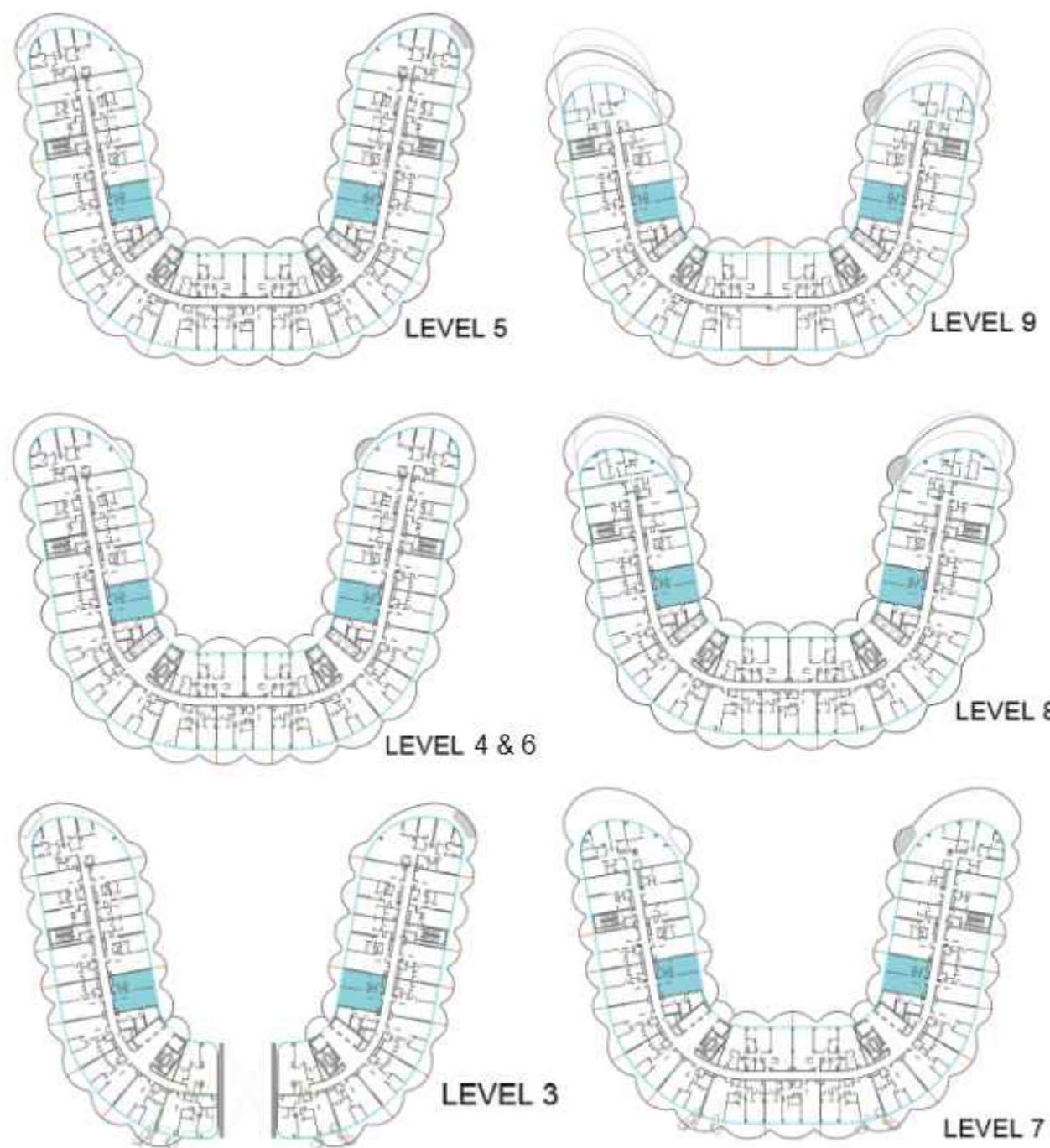

# 1 BEDROOM

## TYPE A2

1	KITCHEN	2.8m x 3.1m
2	LIVING	4m x 6.5m
3	BALCONY	MIN. 1.2m wide
4	BEDROOM	3.8m x 5.9m
5	BATH	3m x 1.9m
6	PWD ROOM	1.8m x 1.8m
7	LAUNDRY	0.9m x 0.9m

	From	To
Suite Area	840.34sq. ft.	840.55sq. ft.
Balcony Area	224.97sq. ft.	337.02sq. ft.
Total Area	1065.30sq. ft.	1177.57sq. ft.





# 1 BEDROOM

## TYPE A3

1	KITCHEN	2.8m x 3.1m
2	LIVING	3.8m x 6.5m
3	BALCONY	MIN 1.0 m wide
4	BEDROOM	3.9m x 4.5m
5	BATH	2m x 2.8m
6	PWD ROOM	1.8m x 1.8m
7	LAUNDRY	1m x 1m

	From	To
Suite Area	843.14sq. ft.	845.7sq. ft.
Balcony Area	357.68sq. ft.	357.58sq. ft.
Total Area	1200.82sq. ft.	1202.65sq. ft.



# 1 BEDROOM

## TYPE A4

1	KITCHEN	2.4m x 2.8m
2	LIVING	3.9m x 6.1m
3	BALCONY	MIN. 1.2m wide
4	BEDROOM	3.8m x 5.7m
5	BATH	1.9m x 2.6m
6	PWD ROOM	1.8m x 1.5m
7	LAUNDRY	1m x 1m

	From	To
Suite Area	848.09sq. ft.	848.20sq. ft.
Balcony Area	236.05sq. ft.	236.05sq. ft.
Total Area	1084.14sq. ft.	1084.25sq. ft.

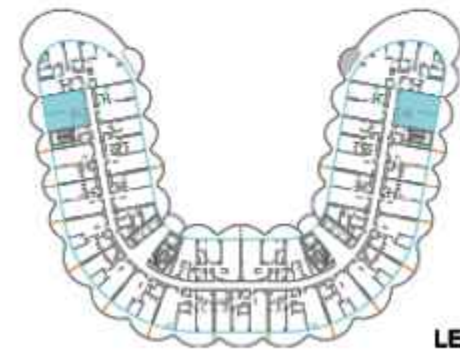

LEVEL 7

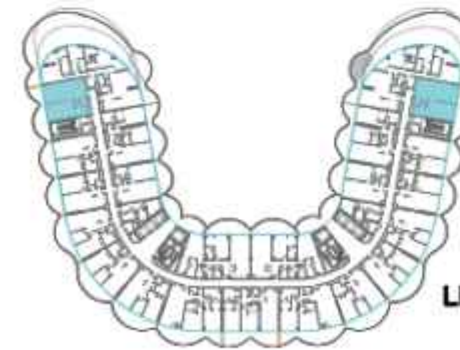

LEVEL 8

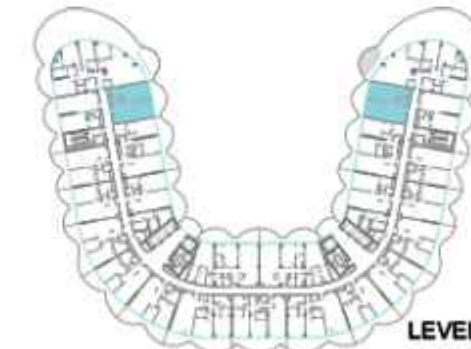

LEVEL 7



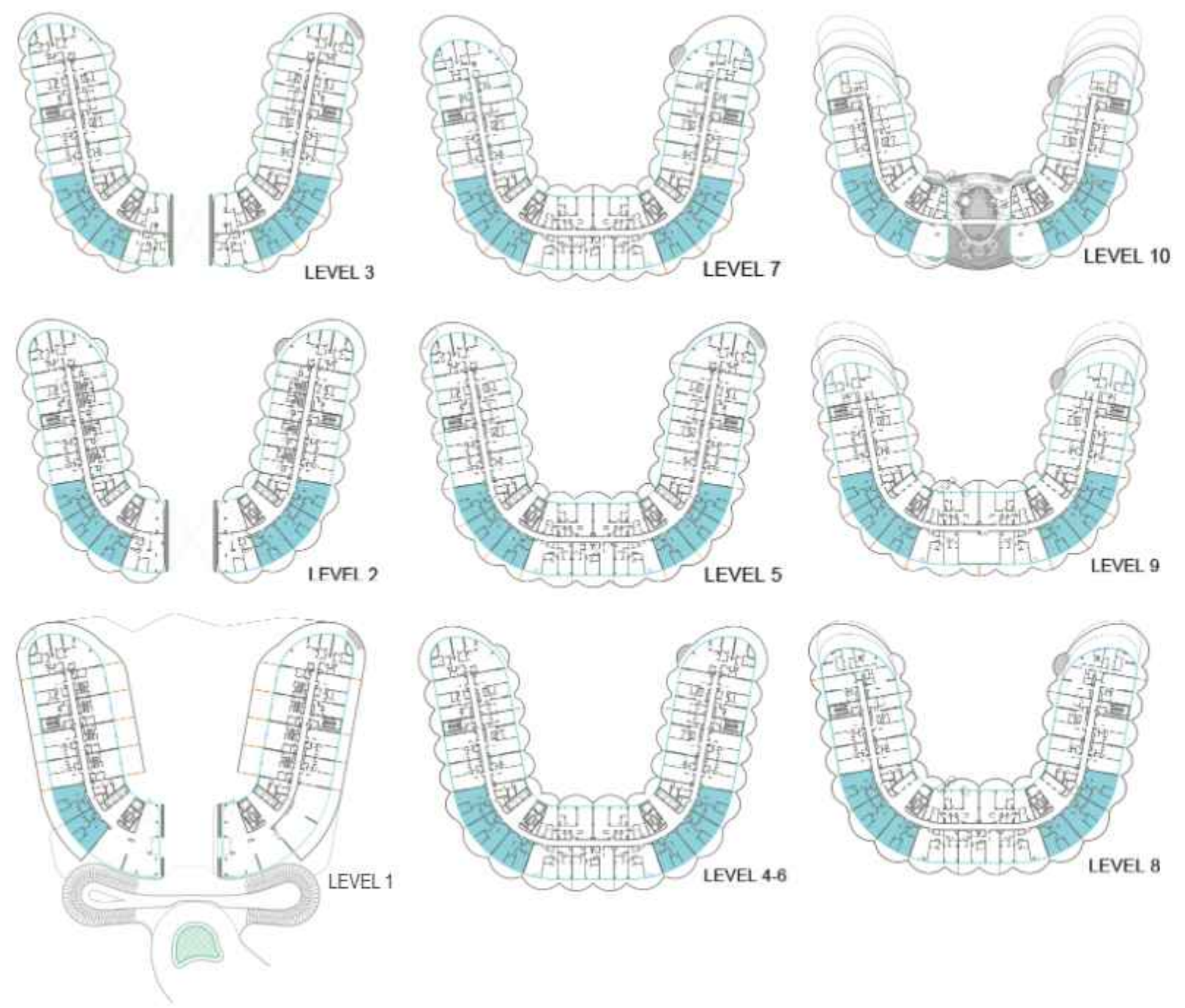

# 1 BEDROOM

## TYPE B

1	KITCHEN	3m x 3.3m
2	LIVING	4.1m x 6.3m
3	STUDY	2.7m x 3.5m
4	BALCONY	MIN. 1.2m wide
5	BEDROOM	3.7m x 5.3m
6	BATH	2m x 2.8m
7	PWD ROOM	1.3m x 1.8m
8	LAUNDRY	0.9m x 1.6m

	From	To
Suite Area	971.23sq. ft.	974.46sq. ft.
Balcony Area	297.08sq. ft.	437.55sq. ft.
Total Area	1268.31sq. ft.	1412.01sq. ft.

\*All images used for illustrative purposes only and do not represent the actual size, feature specifications, fitting, and furnishing. The developer reserves the right to make revision / alterations, at its absolute discretion, without any liability whatsoever.





# 1 BEDROOM

## TYPE C

1	KITCHEN	3m x 3.9m
2	LIVING	4m x 8.6m
3	STUDY	3.1m x 4m
4	BALCONY	Varies
5	BEDROOM	4.5m x 5.5m
6	BATH	1.8m x 3m
7	PWD ROOM	1.8m x 1.8m
8	LAUNDRY	0.9m x 0.9m

	From	To
Suite Area	1390.27sq. ft.	1390.27sq. ft.
Balcony Area	339.17sq. ft.	339.17sq. ft.
Total Area	1729.44sq. ft.	1729.44sq. ft.

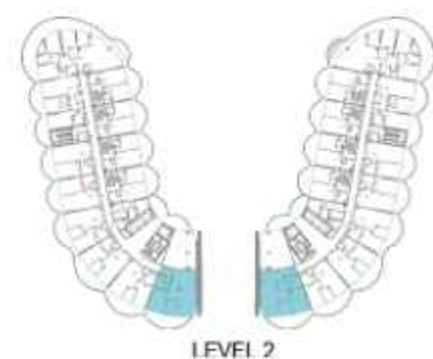

# 1 BEDROOM

## TYPE D

1	KITCHEN	3.7m x 3.5m
2	LIVING	3.7m x 8.1m
3	PWD ROOM	1.4m x 2.8m
4	BEDROOM	2.9m x 5.5m
5	BATH	2.9m x 3.4m
6	LAUNDRY	1m x 1m

	From	To
Suite Area	1030.97sq. ft.	1031.18sq. ft.
Balcony Area	-	-
Total Area	1030.97sq. ft.	1031.18sq. ft.





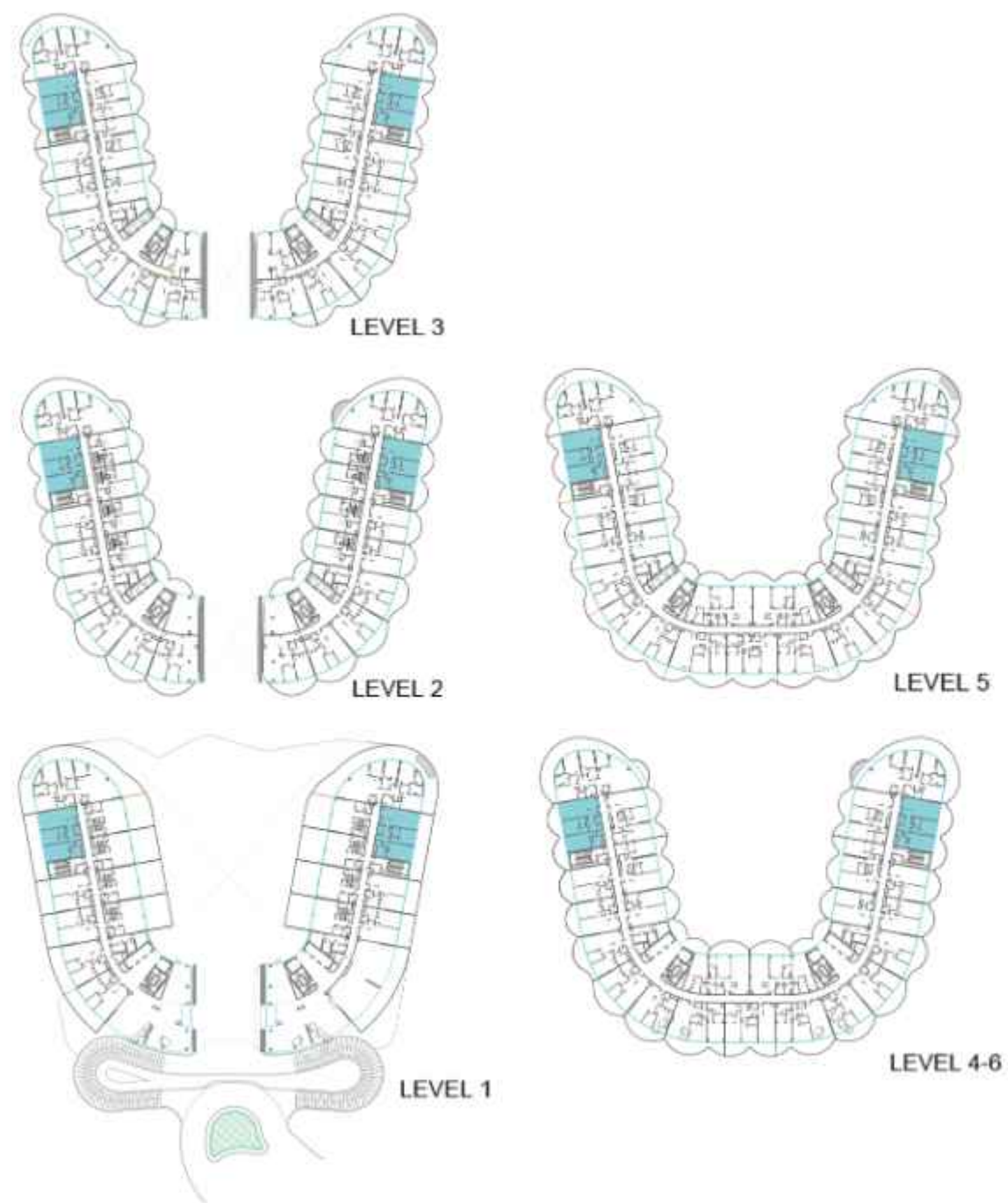

# 2 BEDROOM

## TYPE A

1	KITCHEN	2.9m x 3.0m
2	LIVING	4.3m x 6.6m
3	PWD ROOM	2.1m x 1.6m
4	LAUNDRY	1.2m x 1.6m
5	BEDROOM	3.5m x 3.5m
6	BATH	2.6m x 1.7m
7	BEDROOM	3.9m x 4.2m
8	BATH	2.6m x 2.6m
9	BALCONY	MIN. 1.2m wide

	From	To
Suite Area	1270.57sq. ft.	1271.33sq. ft.
Balcony Area	478.35 sq. ft.	619.21sq. ft.
Total Area	1748.92sq. ft.	1890.57sq. ft.



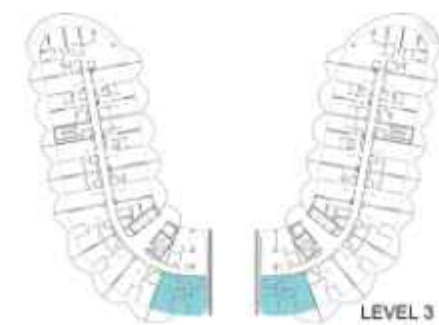

# 2 BEDROOM

## TYPE B

1	KITCHEN	2.8m x 3.7m
2	LIVING	4.9m x 6.2m
3	BALCONY	Varies
4	PWD ROOM	1.7m x 1.4m
5	BEDROOM	4.2m x 3.6m
6	BATH	2.6m x 1.8m
7	BEDROOM	4.0m x 4.7m
8	BATH	3.2m x 2.7m
9	LAUNDRY	0.9m x 1.4m

	From	To
Suite Area	1326.01sq. ft.	1326.01sq. ft.
Balcony Area	170.39 sq. ft.	170.61 sq. ft.
Total Area	1496.40sq. ft.	1496.61sq. ft.



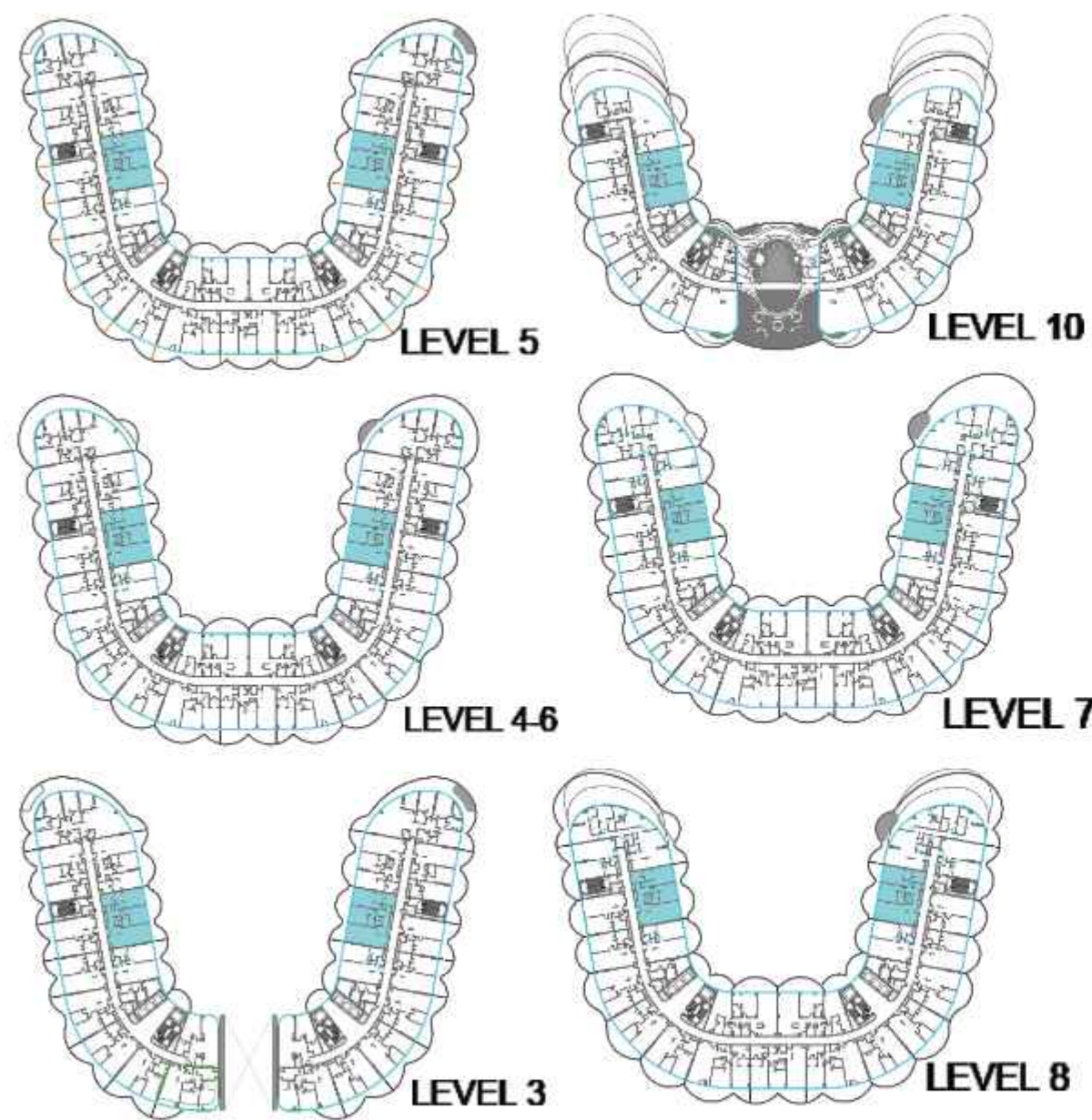

## 2 BEDROOM TYPE C

1	KITCHEN	2.9m x 3.1m
2	LIVING	4.3m x 6.5m
3	BALCONY	Min 1.2m wide
4	BEDROOM	4.2m x 3.5m
5	BATH	2.6m x 1.6m
6	BEDROOM	3.8m x 4.7m
7	BATH	2.5m x 2.9m
8	PWD ROOM	1.9m x 0.9m
9	LAUNDRY	1.2m x 1.1m

	From	To
Suite Area	1267.34 sq. ft.	1281.34sq. ft.
Balcony Area	343.48 sq. ft.	350.47sq. ft.
Total Area	1610.82sq. ft.	1631.81sq. ft.





## 2 BEDROOM TYPE C1

1	KITCHEN	2.9m x 3.1m
2	LIVING	4.3m x 6.2m
3	PWD ROOM	1.9m x 1m
4	BEDROOM	3.6m x 3.9m
5	BATH	2.6m x 1.7m
6	BEDROOM	3.8m x 4.7m
7	BATH	2.5m x 2.9m
8	LAUNDRY	1.9m x 0.9m
9	BALCONY	MIN. 1.6m wide

	From	To
Suite Area	1280.80 sq. ft.	1281.23 sq. ft.
Balcony Area	347.78 sq. ft.	352.20 sq. ft.
Total Area	1628.58 sq. ft.	1633.42 sq. ft.

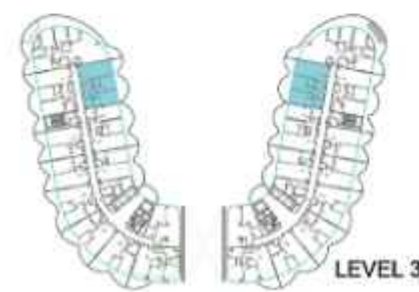
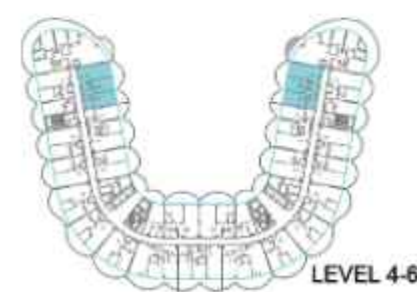

## 2 BEDROOM TYPE C2

1	KITCHEN	2.8m x 3m
2	LIVING	4.1m x 6.5m
3	PWD ROOM	1.8m x 1.6m
4	BEDROOM	3.9m x 4.1m
5	BATH	2.6m x 1.6m
6	LAUNDRY	1.2m x 1.1m
7	BEDROOM	3.8m x 4.7m
8	BATH	2.5m x 2.9m
9	BALCONY	MIN. 1.2m wide

	From	To
Suite Area	1277.78sq. ft.	1277.89 sq. ft.
Balcony Area	353.27sq. ft.	353.38 sq. ft.
Total Area	1631.06sq. ft.	1631.27sq. ft.





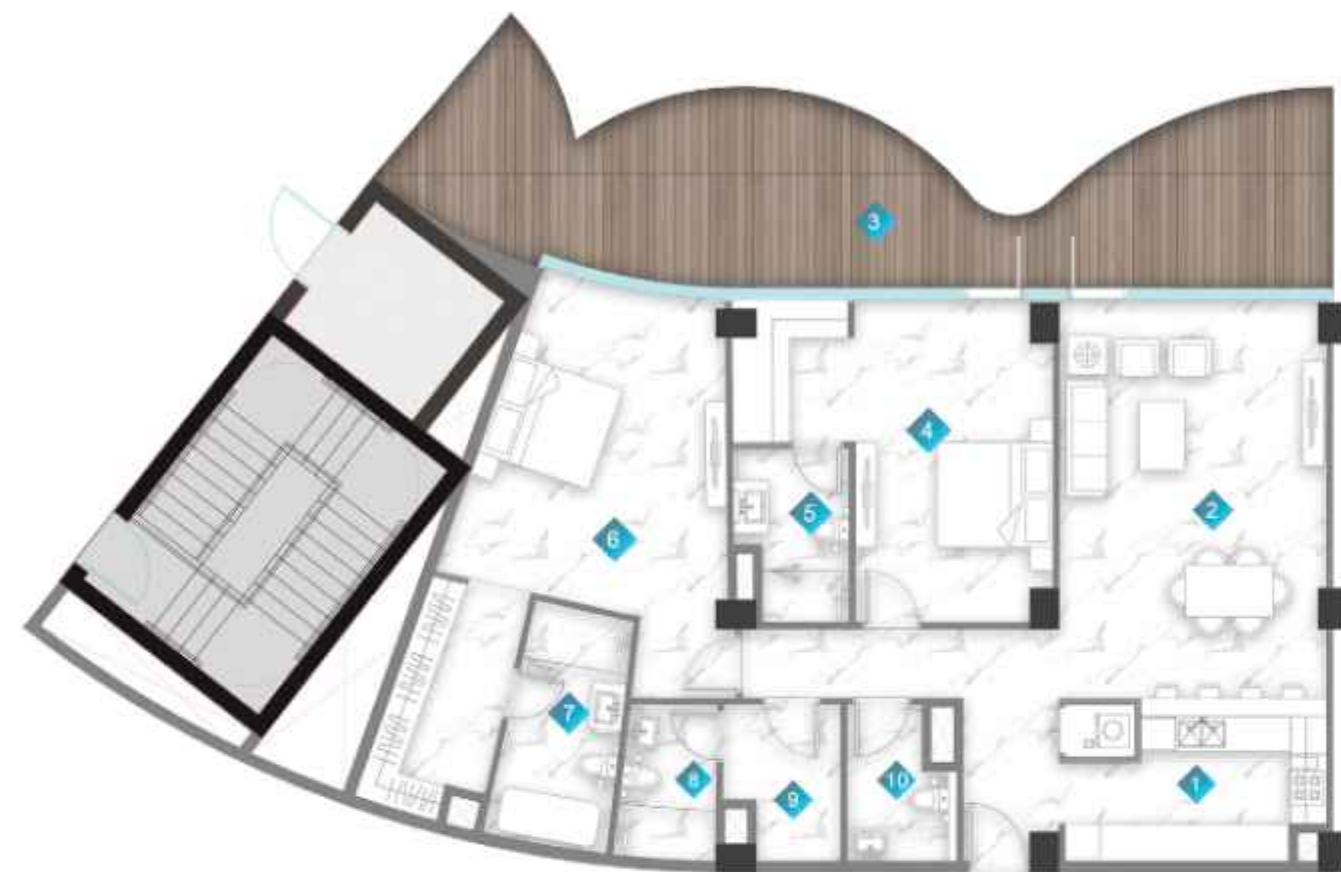

ENTRY



## 2 BEDROOM TYPE D

1	KITCHEN	3.2m x 2.8m
2	LIVING	4.6m x 6.8m
3	BALCONY	MIN. 1.3m wide
4	BEDROOM	3.4m x 5.5m
5	BATH	2.0m x 2.9m
6	BEDROOM	3.1m x 5.5m
7	BATH	1.7m x 4m
8	BATH	2.7m x 1.7m
9	STORE	2m x 2.7m
10	PWD ROOM	1.8m x 2.7m

	From	To
Suite Area	1572.18 sq. ft.	1576.27 sq. ft.
Balcony Area	296.33 sq. ft.	396.11 sq. ft.
<b>Total Area</b>	<b>1868.51sq. ft.</b>	<b>1972.38 sq. ft.</b>



ENTRY



## 2 BEDROOM TYPE E

1	KITCHEN	4.4m x 2.6m
2	LIVING	4.1m x 4.2m
3	DINING	4.2m x 4.2m
4	BALCONY	MIN. 3.2m wide
5	BEDROOM	3.7m x 3.9m
6	BATH	1.6m x 3.4m
7	PWD ROOM	1.9m x 1.6m
8	LAUNDRY	2.1m x 1m
9	BEDROOM	3.6m x 4m
10	BATH	3.1m x 2.6m
11	STORE	1.6m x 2.6m
12	BATH	1.5m x 1.6m

	From	To
Suite Area	1301.89 sq. ft.	1303.08 sq. ft.
Balcony Area	586.96 sq. ft.	586.85 sq. ft.
<b>Total Area</b>	<b>1888.85 sq. ft.</b>	<b>1889.93 sq. ft.</b>



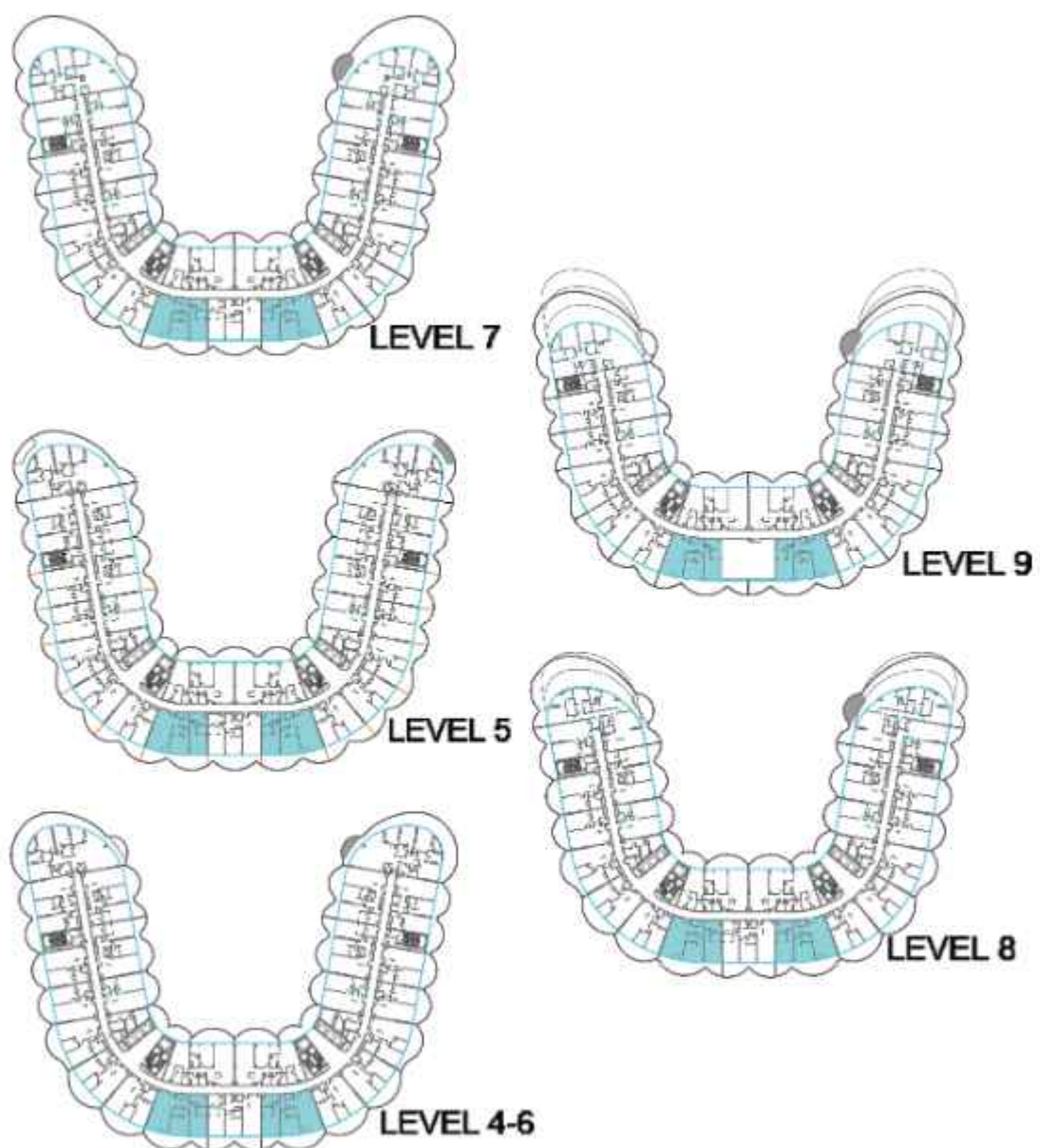

# 2 BEDROOM

## TYPE F

1	KITCHEN	3m x 3.2m
2	LIVING	5.3m x 6.6m
3	BALCONY	Varies
4	BEDROOM	4.8m x 3.6m
5	BATH	2.6m x 1.9m
6	BEDROOM	4.1m x 4.7m
7	BATH	2.5m x 2.7m
8	LAUNDRY	1.1m x 1.4m
9	PWD ROOM	1.7m x 1.4m

	From	To
Suite Area	1360.99sq. ft.	1350.22sq. ft.
Balcony Area	432.92sq. ft.	625.49sq. ft.
Total Area	1793.91sq. ft.	1975.72sq. ft.

\*All images used for illustrative purposes only and do not represent the actual size, feature specifications, fitting, and furnishing. The developer reserves the right to make revision / alterations, at its absolute discretion, without any liability whatsoever.



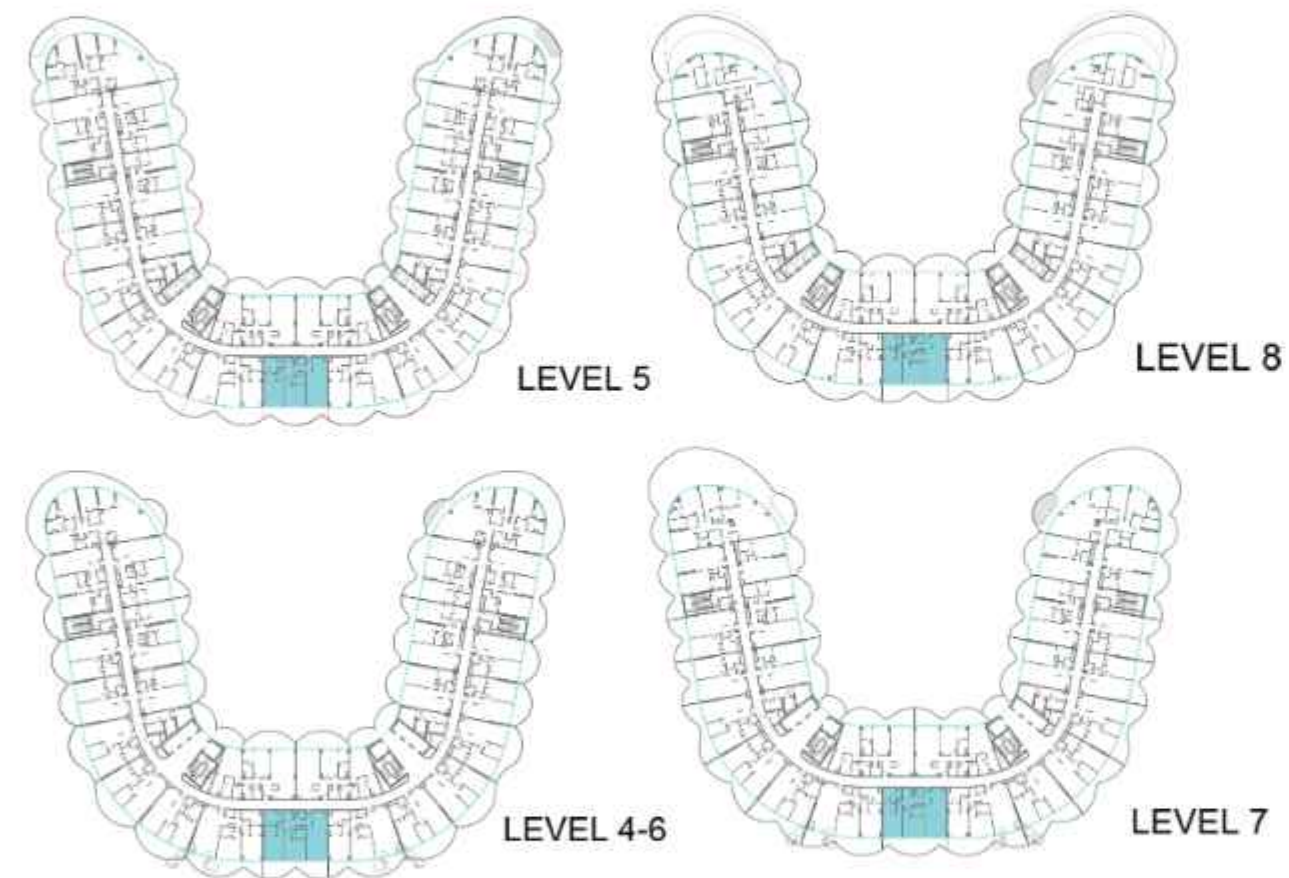

# 2 BEDROOM

## TYPE G

1	KITCHEN	3m x 3.1m
2	LIVING	4.3m x 6.5m
3	BALCONY	MIN. 1.3m wide
4	BEDROOM	4.2m x 4.1m
5	BATH	2.6m x 1.7m
6	PWD ROOM	2.1m x 1.7m
7	LAUNDRY	1.8m x 1.7m
8	BEDROOM	3.8m x 4.7m
9	BATH	2.5m x 2.9m

	From	To
Suite Area	1296.30sq. ft.	1296.41sq. ft.
Balcony Area	350.80sq. ft.	390.08sq. ft.
Total Area	1647.09sq. ft.	1686.49sq. ft.



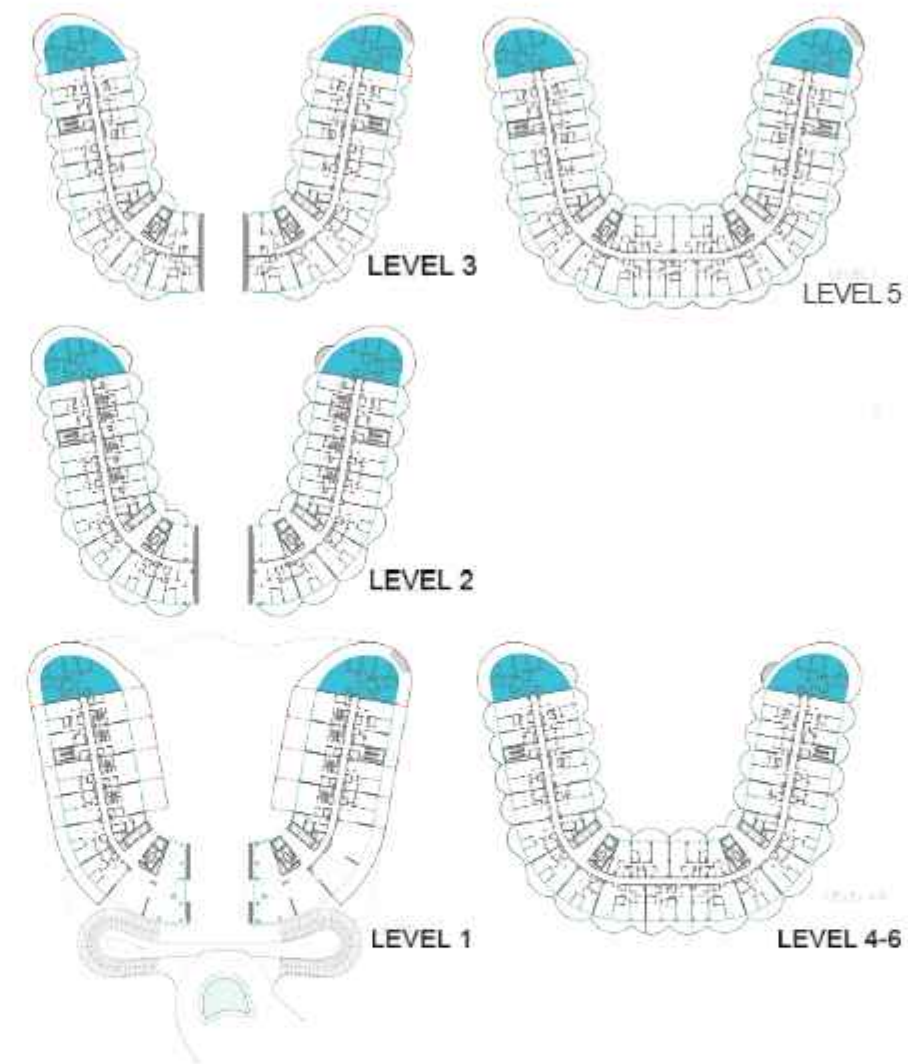

	From	To
Suite Area	2135.02 sq. ft.	2135.56 sq. ft.
Balcony Area	1140.87 sq. ft.	1644.19 sq. ft.
Total Area	3275.89sq. ft.	3779.75 sq. ft.

# 3 BEDROOM

## TYPE A

1	KITCHEN	3.6m x 2.5m
2	LIVING	8m x 9.5m
3	BALCONY	MIN.1.2m wide
4	STUDY	3.5m x 4.2m
5	BEDROOM	3.4m x 4.2m
6	BATH	2.2m x 2.7m
7	PWD ROOM	1.6m x 2.1m
8	M. BEDROOM	3.7m x 3.7m
9	BATH	2.6m x 3.0m
10	BATH	2.5m x 3.4m
11	BEDROOM	5.0m x 3.9m
12	STORE	2.4m x 2.8m
13	LAUNDRY	1.1m x 0.9m
14	BATH	1.9m x 1.6m
15	PRIVATE POOL	



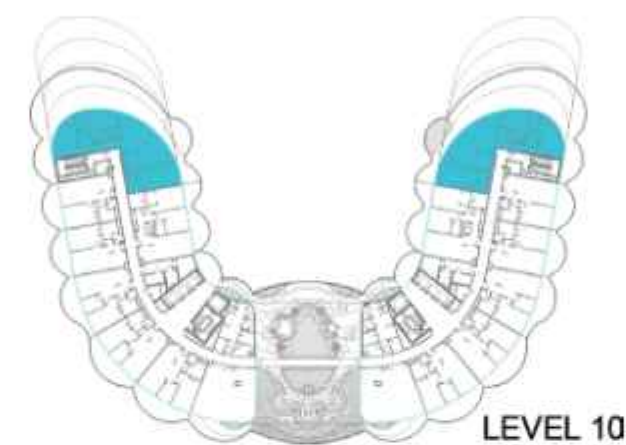
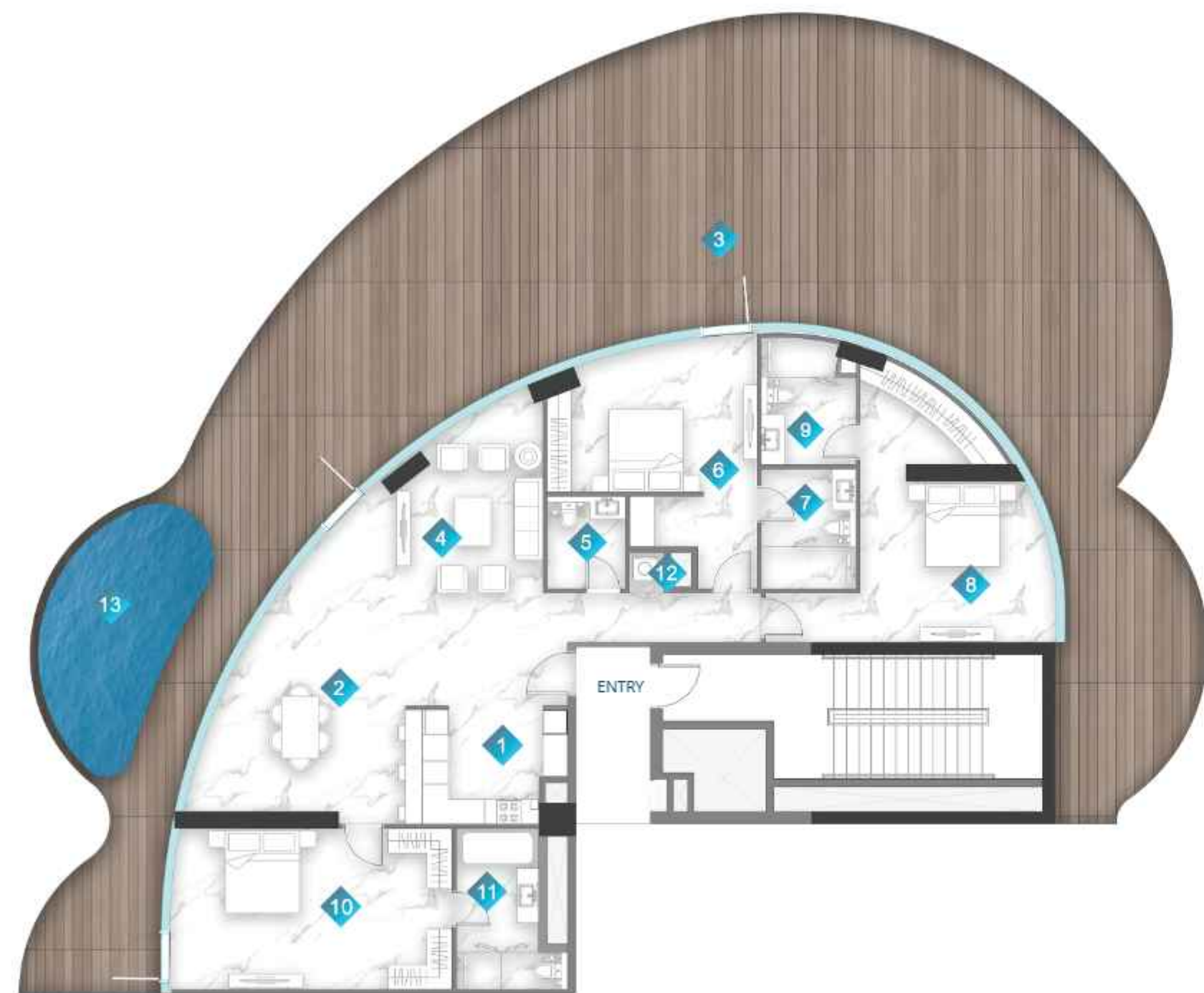

	From	To
Suite Area	2031.15sq. ft.	2030.29sq. ft.
Balcony Area	2467.63sq. ft.	2468.70sq. ft.
Total Area	4498.78sq. ft.	4498.99sq. ft.

# 3 BEDROOM

## TYPE B

1	KITCHEN	3.2m x 2.8m
2	DINING	5.4m x 2.8m
3	BALCONY	MIN. 1.5m wide
4	LIVING	7.7m x 3.5m
5	PWD ROOM	1.9m x 2.2m
6	BEDROOM	4.4m x 3.0m
7	BATH	2.2m x 2.9m
8	BEDROOM	4.8m x 6.8m
9	BATH	2.2m x 2.8m
10	BEDROOM	6.5m x 3.9m
11	BATH	2.7m x 3.9m
12	LAUNDRY	1m x 1m
13	PRIVATE POOL	



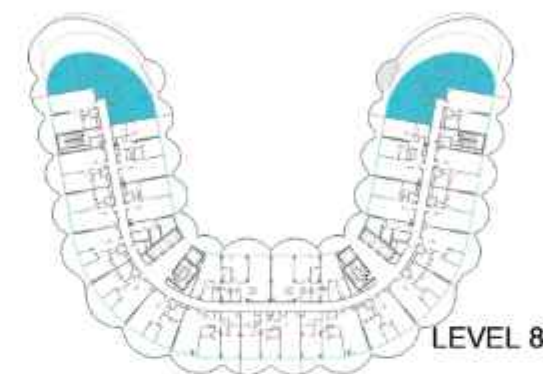
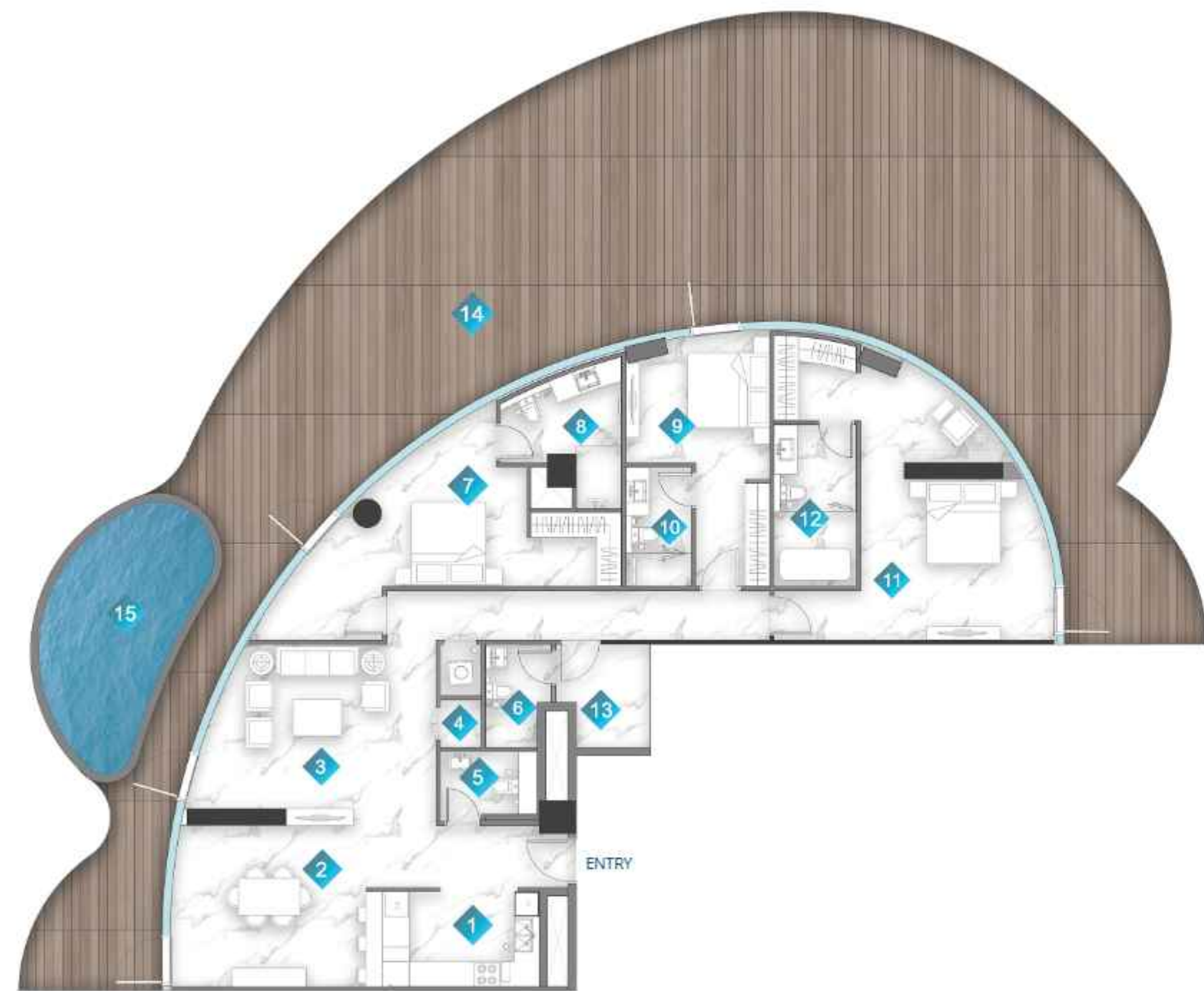

	From	To
Suite Area	2081.09sq. ft.	2082.31sq. ft.
Balcony Area	2353.53sq. ft.	2353.31sq. ft.
Total Area	4434.62sq. ft.	4434.62sq. ft.

# 3 BEDROOM

## TYPE C

1	KITCHEN	4.2m x 2.4m
2	DINING	4.7m x 3.9m
3	LIVING	6m x 4m
4	LAUNDRY	1.2m x 1m
5	PWD ROOM	2.3m x 1.5m
6	BEDROOM	6.7m x 4.4m
7	BATH	1.2m x 2.5m
8	BATH	3.6m x 2.9m
9	BEDROOM	3.5m x 3.1m
10	BATH	1.6m x 2.9m
11	BEDROOM	4.7m x 7.2m
12	BATH	2m x 3.9m
13	STORE	1.7m x 2.5m
14	BALCONY	MIN. 1.54 m wide
15	PRIVATE POOL	





	From	To
Suite Area	1431.71sq. ft.	1433.43sq. ft.
Balcony Area	766.28sq. ft.	765.64sq. ft.
Total Area	2197.99sq. ft.	2199.07sq. ft.

## 3 BEDROOM TYPE D

1	KITCHEN	3m x 3m
2	LIVING	6.3m x 4.4m
3	PWD ROOM	1.7m x 1.6m
4	BEDROOM	3.5m x 3.9m
5	BATH	2.2m x 3m
6	BEDROOM	3.9m x 3.6m
7	BATH	1.8m x 1.8m
8	BEDROOM	3.6m x 4.1m
9	BATH	1.6m x 2.3m
10	BALCONY	MIN. 3.2m wide



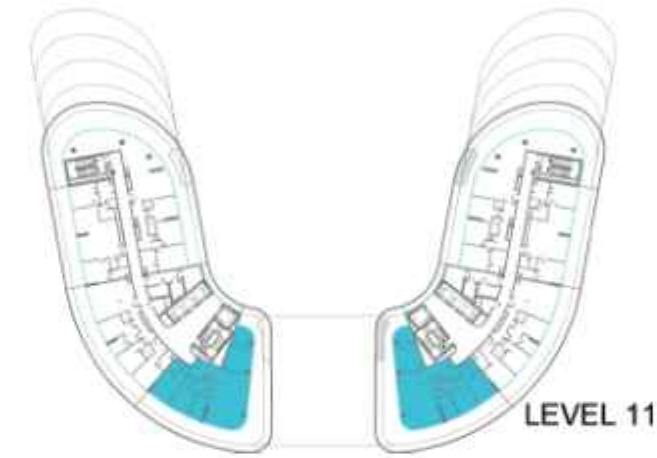
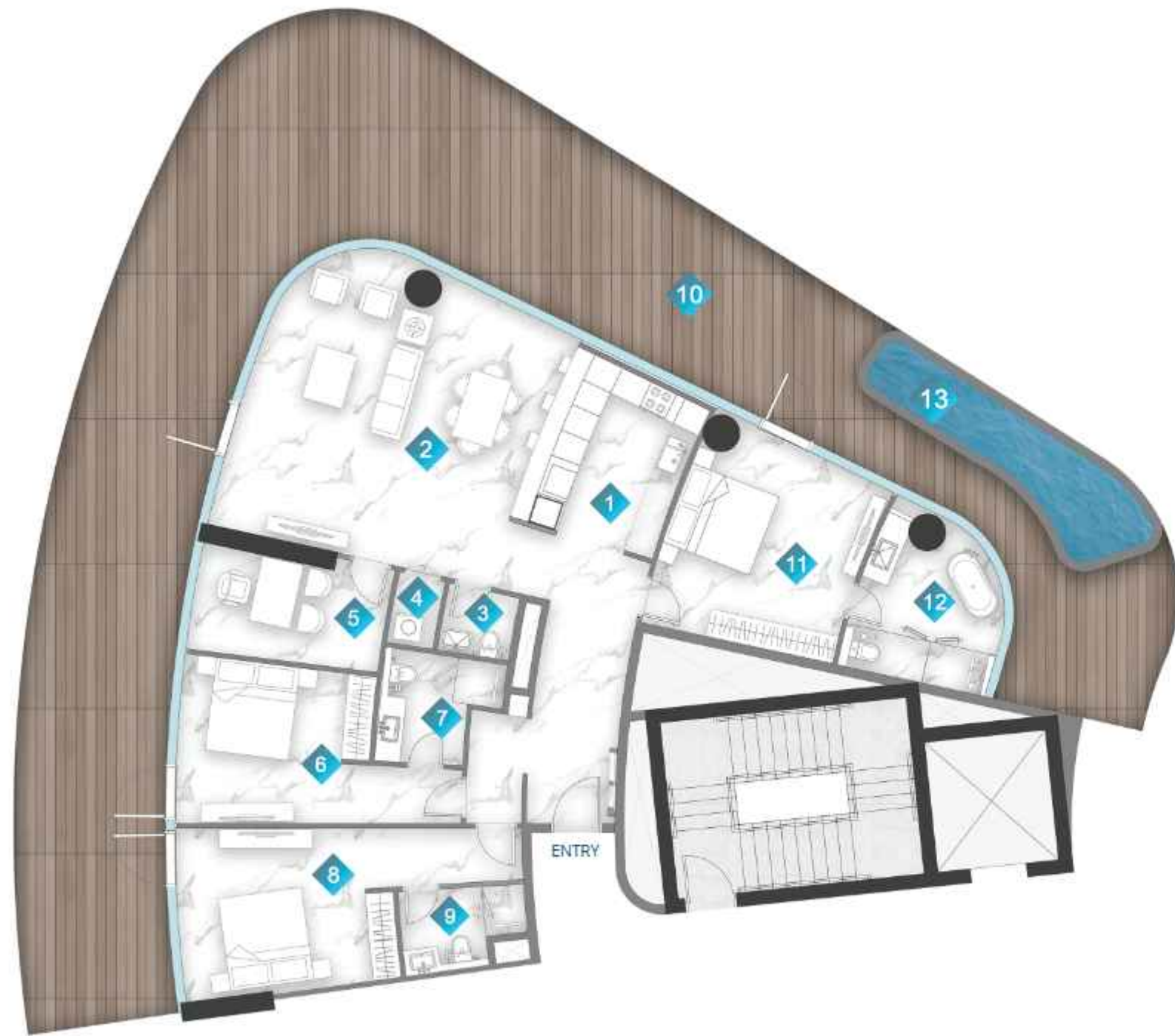

	From	To
Suite Area	1781.21sq. ft.	1781.64sq. ft.
Balcony Area	1587.68sq. ft.	1587.78sq. ft.
Total Area	3368.89sq. ft.	3369.43sq. ft.

# 3 BEDROOM

## TYPE E

1	KITCHEN	3.1m x 3.9m
2	LIVING	6.2m x 6.5m
3	PWD ROOM	1.5m x 1.4m
4	LAUNDRY	1m x 1.4m
5	STUDY	4.1m x 2.3m
6	BEDROOM	3.5m x 3.7m
7	BATH	1.9m x 2.2m
8	BEDROOM	4.6m x 3.7m
9	BATH	2.7m x 1.8m
10	BALCONY	MIN. 3m wide
11	BEDROOM	4.2m x 3.2m
12	BATH	3.2m x 3.7m
13	POOL	



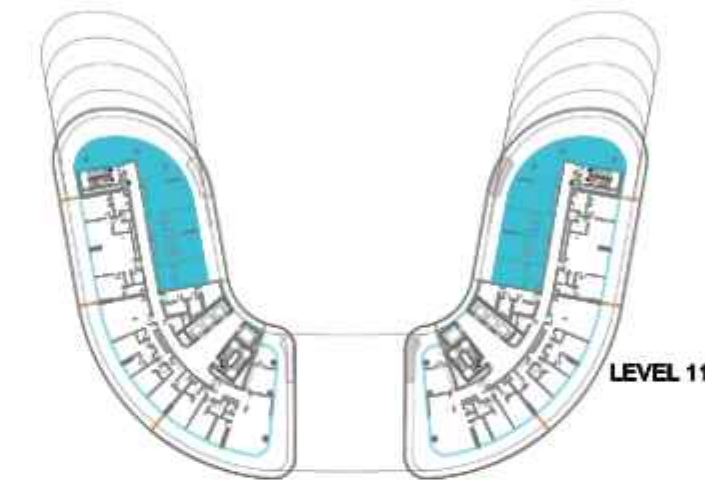
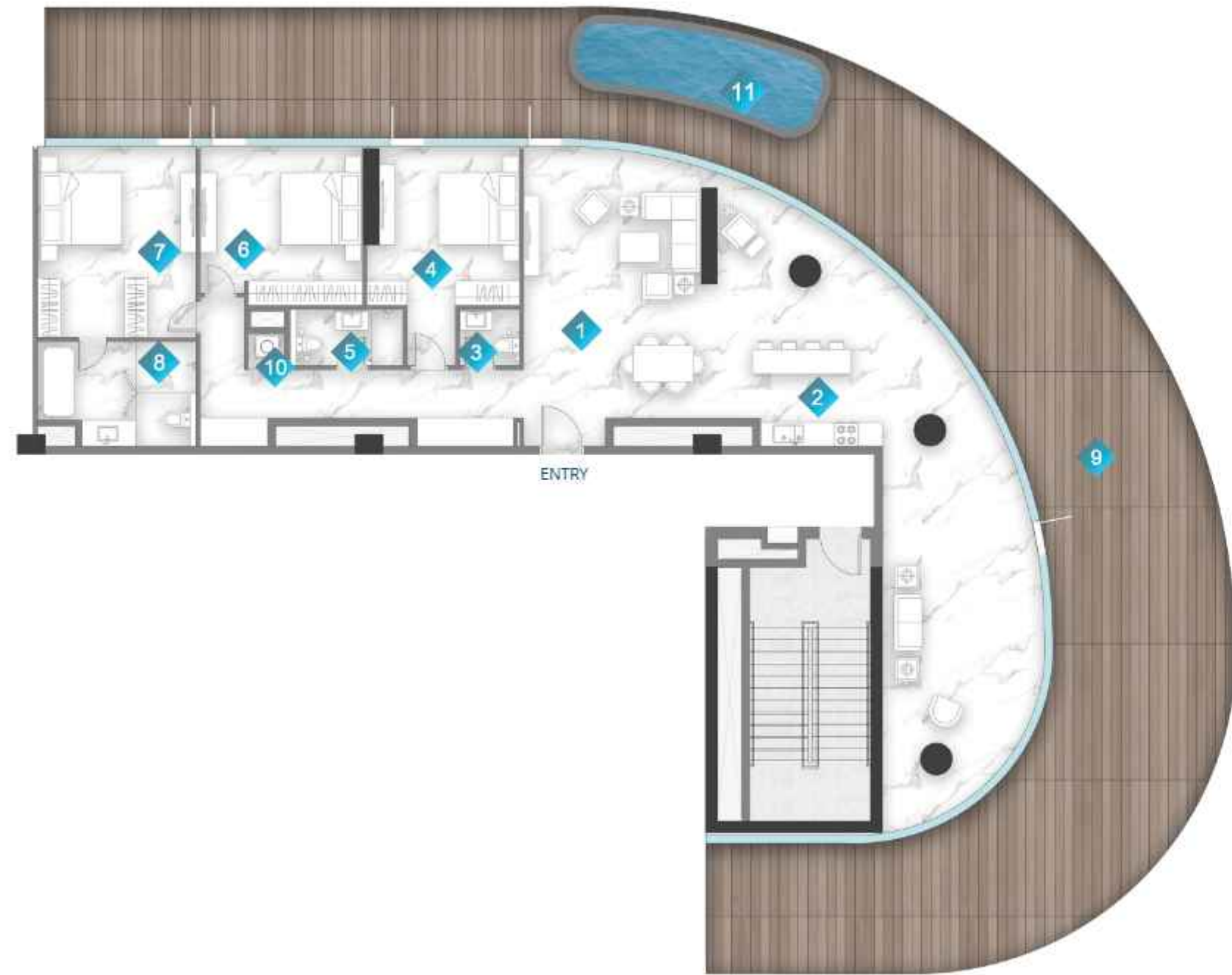

	From	To
Suite Area	2018.45sq. ft.	2021.35sq. ft.
Balcony Area	1997.57sq. ft.	1995.31sq. ft.
Total Area	4016.01sq. ft.	4016.66sq. ft.

## 3 BEDROOM TYPE F

1	LIVING	8.9m x 7.4m
2	KITCHEN	3m x 2.6m
3	PWD ROOM	1.5m x 1.3m
4	BEDROOM	3.3m x 3.4m
5	BATH	2.9m x 1.4m
6	BEDROOM	4.0m x 3.4m
7	BEDROOM	3.3m x 3.9m
8	BATH	3.9m x 2.6m
9	BALCONY	MIN. 1.2m wide
10	LAUNDRY	0.9m x 0.9m
11	PRIVATE POOL	



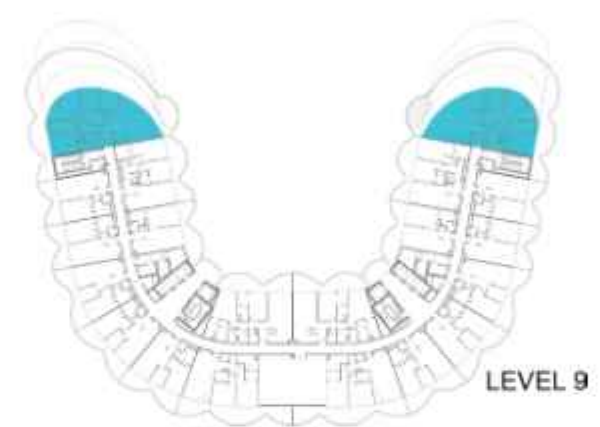

	From	To
Suite Area	2120.28sq. ft.	2119.31sq. ft.
Balcony Area	2469.13sq. ft.	2470.32sq. ft.
Total Area	4589.41sq. ft.	4589.63sq. ft.

# 3 BEDROOM

## TYPE G

1	KITCHEN	3.5m x 2.5m
2	LIVING	7.2m x 9.3m
3	STUDY	3.5m x 4.5m
4	BATH	2.2m x 2.6m
5	BEDROOM	3.5m x 3.6m
6	STORE	2.7m x 2.8m
7	BATH	1.7m x 1.7m
8	LAUNDRY	1.0m x 0.8m
9	BEDROOM	3.9m x 3.6m
10	BATH	3.9m x 2.6m
11	BEDROOM	4.4m x 3.9m
12	BATH	3.2m x 2.0m
13	BALCONY	MIN. 1.5m wide
14	PWD ROOM	1.9m x 2.1m
15	PRIVATE POOL	

\*All images used for illustrative purposes only and do not represent the actual size, feature specifications, fitting, and furnishing. The developer reserves the right to make revision / alterations, at its absolute discretion, without any liability whatsoever.



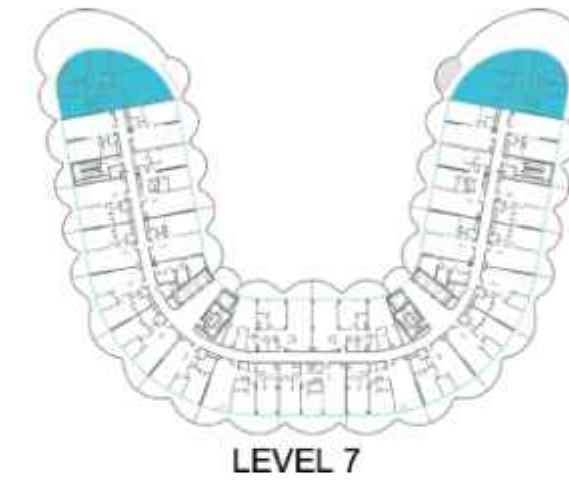
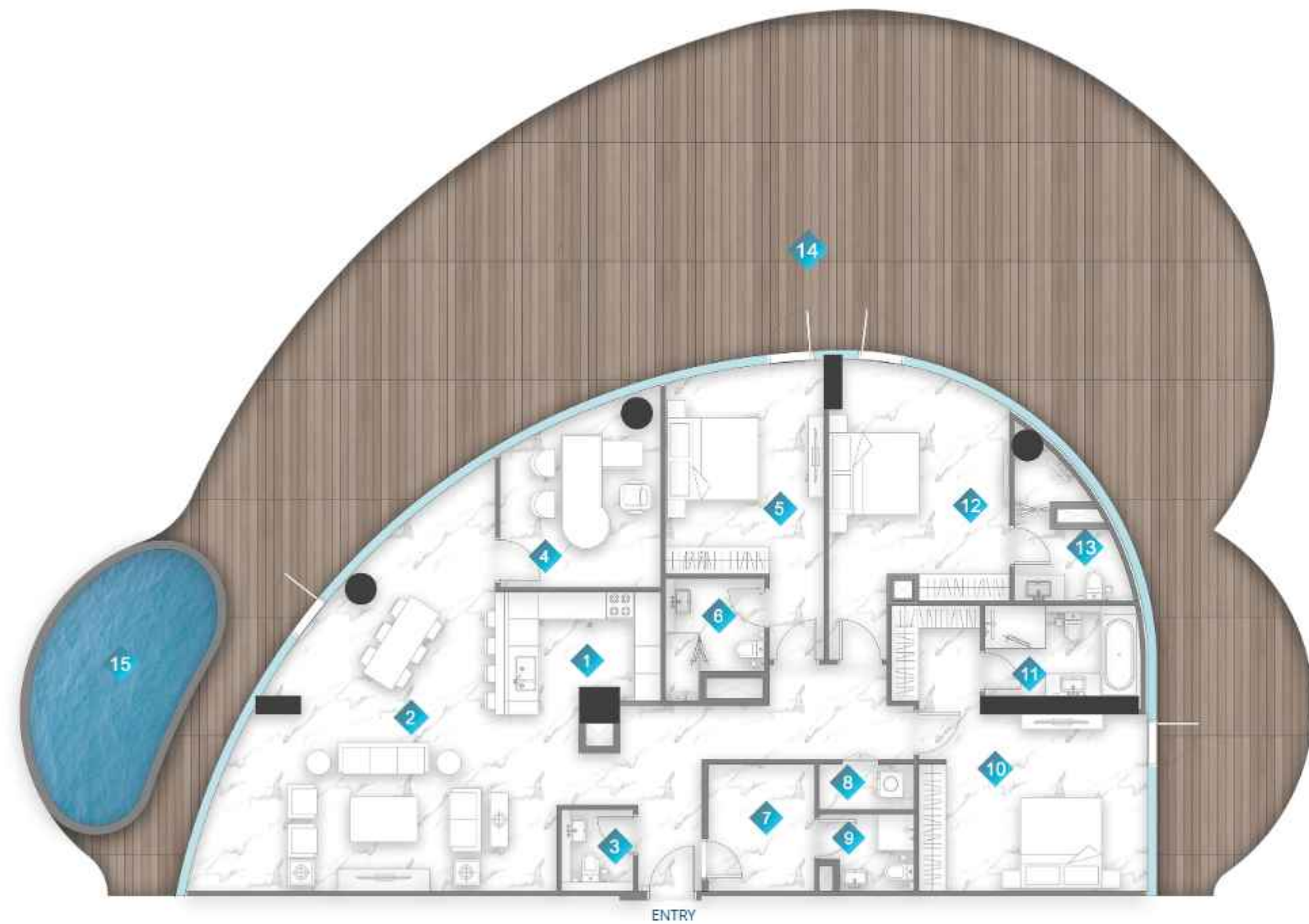

	From	To
Suite Area	2145.03sq. ft.	2145.14sq. ft.
Balcony Area	2351.27sq. ft.	2351.70sq. ft.
<b>Total Area</b>	<b>4496.30sq. ft.</b>	<b>4494.84sq. ft.</b>

# 3 BEDROOM

## TYPE H

1	KITCHEN	3.5m x 2.7m
2	LIVING	8.1m x 9.5m
3	PWD ROOM	1.6m x 1.7m
4	STUDY	3.5m x 4.5m
5	BEDROOM	3.5m x 3.6m
6	BATH	2.2m x 2.6m
7	STORE	2.4m x 2.8m
8	LAUNDRY	2.1m x 1m
9	BATH	1.7m x 1.7m
10	BEDROOM	3.9m x 4.4m
11	BATH	3.3m x 1.9m
12	BEDROOM	4m x 3.5m
13	BATH	2.6m x 4.1m
14	BALCONY	MIN. 1.2m wide
15	PRIVATE POOL	



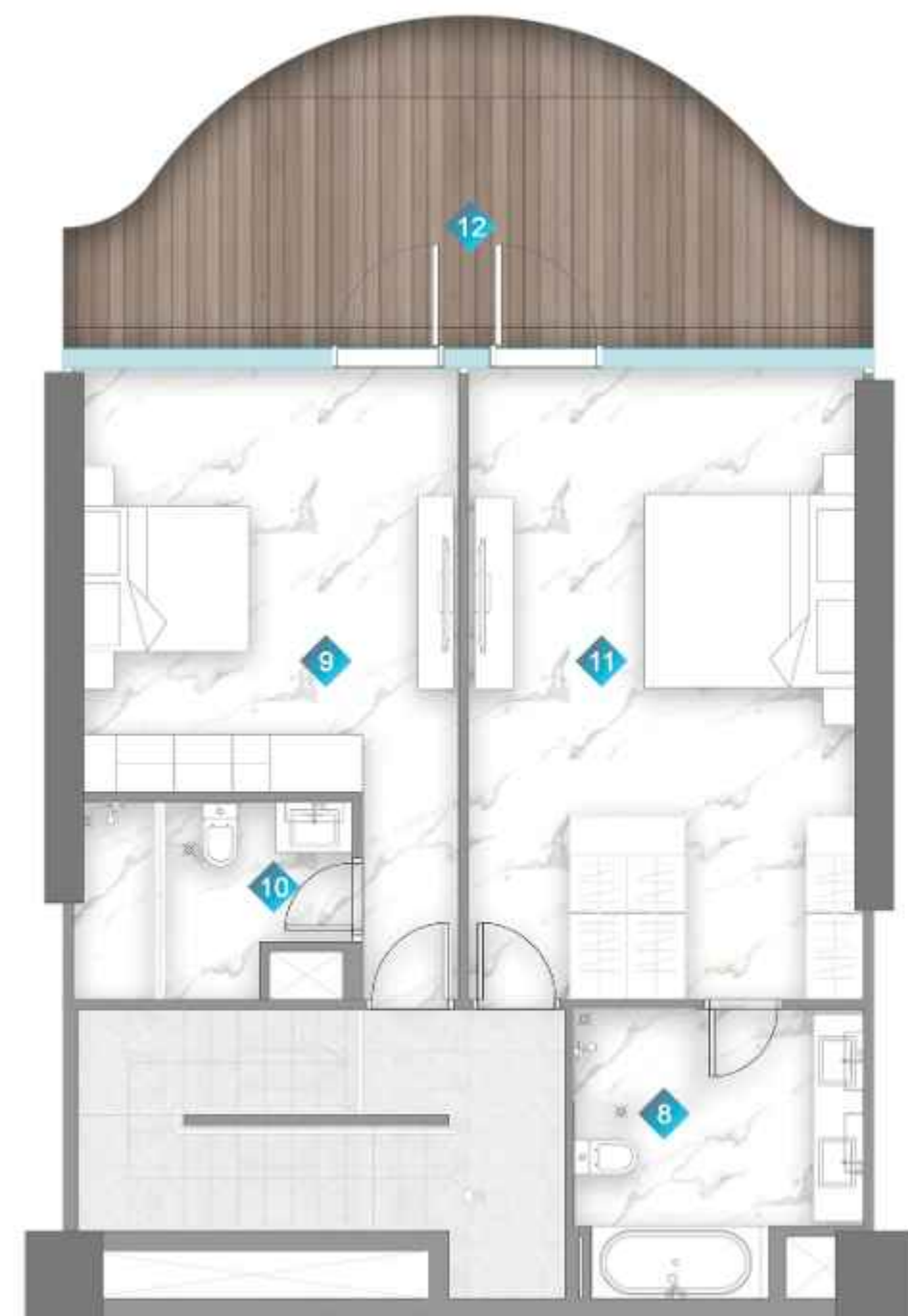

UPPER LEVEL



LOWER LEVEL

ENTRY

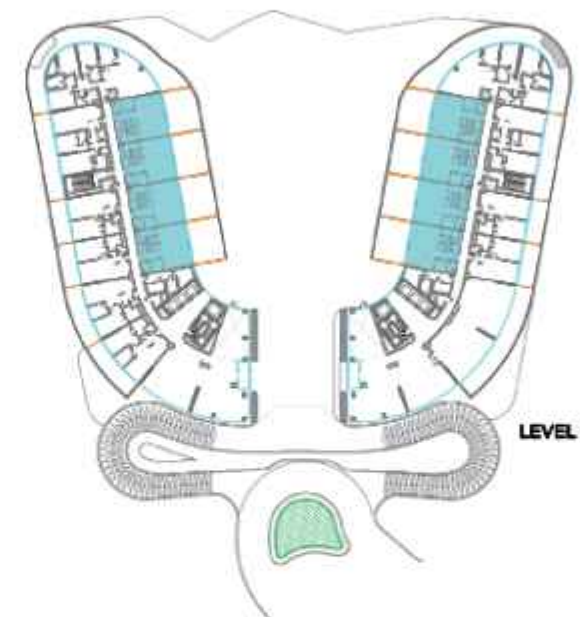

LEVEL 1

	From	To
Suite Area	1665.72 sq. ft.	1693.161sq. ft.
Balcony Area	800.94 sq. ft.	817.63 sq. ft.
Total Area	2466.66 sq. ft.	2510.79 sq. ft.

# TOWNHOUSE

1	PWD ROOM	1.7m x 1.6m
2	BATH	2.2m x 1.6m
3	LAUNDRY	1.3m x 1.1m
4	STORE	2.2m x 2.4m
5	KITCHEN	2.6m x 5.4m
6	LIVING	5.6m x 5.5m
7	BALCONY	MIN. 6.4m wide
8	BATH	3m x 3m
9	BEDROOM	4.0m x 4.4m
10	BATH	2.9m x 2.0m
11	BEDROOM	4.1m x 4.6m
12	BALCONY	MIN. 1.3m wide



# PENTHOUSE



LEVEL 12

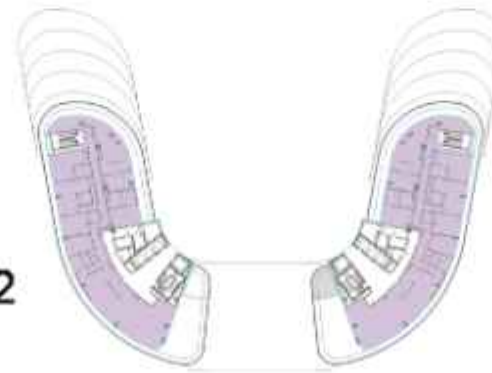

1	KITCHEN	6.3m x 5.2m	10	BEDROOM	4.05m x 6.7m
2	LIVING	16.3m x 7.4m	11	BATH	2.4m x 2.7m
3	PWD ROOM	1.6m x 1.2m	12	BEDROOM	10.1m x 6m
4	BATH	2.8m x 1.5m	13	BATH	3.4m x 5.3m
5	STUDY	3.6m x 5.3m	14	BEDROOM	5.4m x 4.2m
6	BEDROOM	4.2m x 3.1m	15	BATH	2.5m x 3.4m
7	BATH	2.3m x 2.3m	16	BALCONY	MIN. 1.2 m
8	BEDROOM	4m x 6m	17	LAUNDRY	1m x 1.2m
9	BATH	3m x 2.4m	18	PRIVATE POOL	

	From	To
Suite Area	5547.72 sq. ft.	5549.44sq. ft.
Balcony Area	3111.42 sq. ft.	3111.52 sq. ft.
Total Area	8659.14 sq. ft.	8660.97 sq. ft.



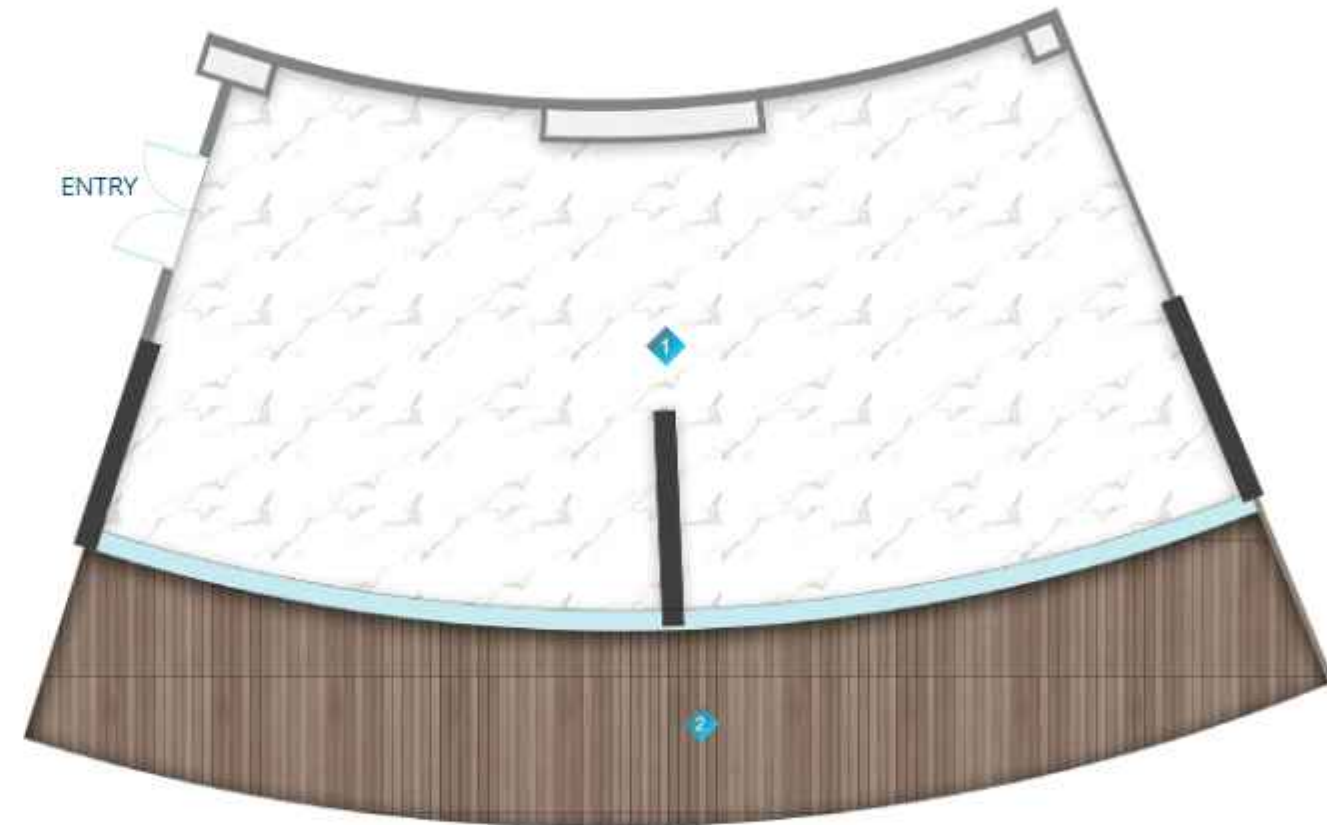

# RETAIL

1	RETAIL	21.2m x 9.6m
2	BALCONY	21.2m x 3.4m

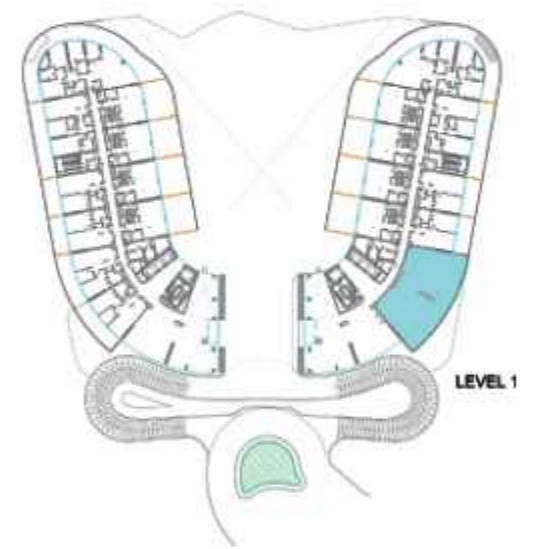

Suite Area	1937.72sq. ft.
Balcony Area	868.22 sq. ft.
<b>Total Area</b>	<b>2805.94 sq. ft.</b>

\*All images used for illustrative purposes only and do not represent the actual size, feature specifications, fitting, and furnishing. The developer reserves the right to make revision / alterations, at its absolute discretion, without any liability whatsoever.



# 楼层平面图



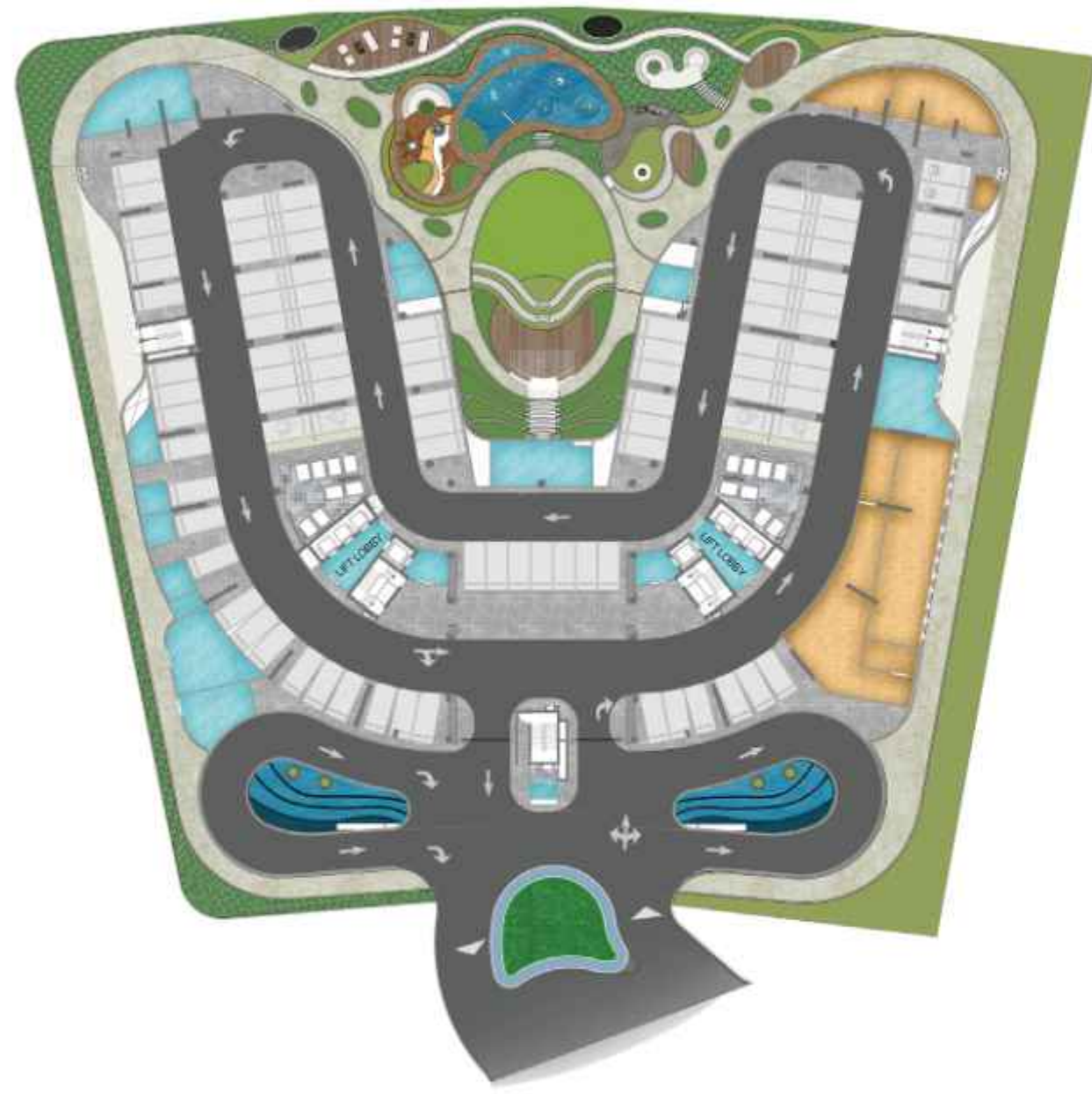

# GROUND FLOOR



# LEVEL 1

- 1BR UNITS
- 2BR UNITS
- 3BR UNITS
- DUPLEX



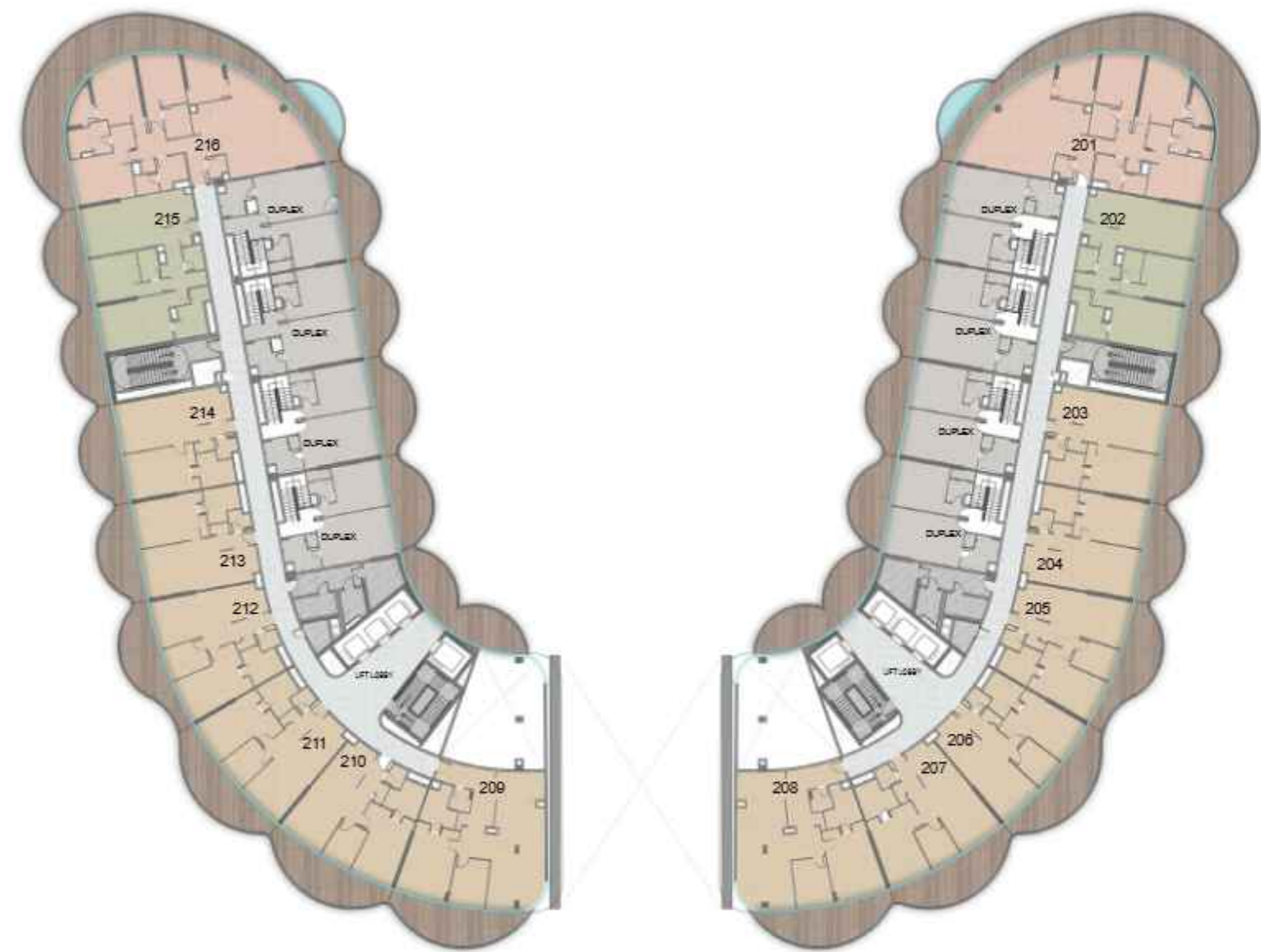

## LEVEL 2

- 1BR UNITS
- 2BR UNITS
- 3BR UNITS
- DUPLEX

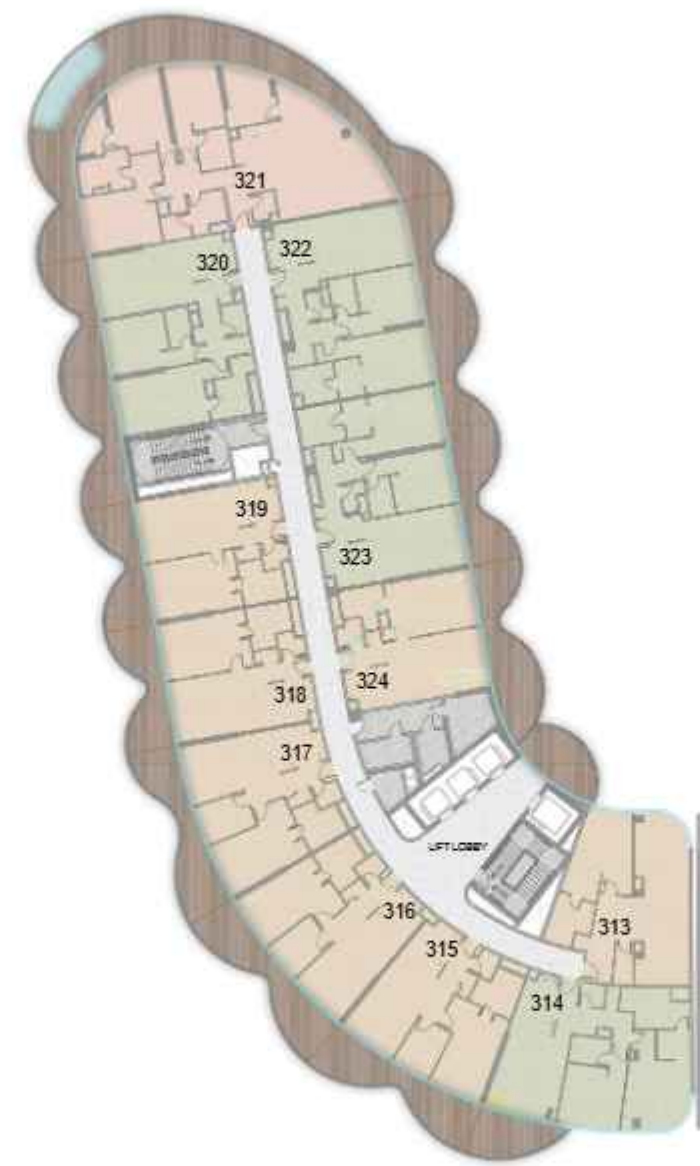

## LEVEL 3

- 1BR UNITS
- 2BR UNITS
- 3BR UNITS



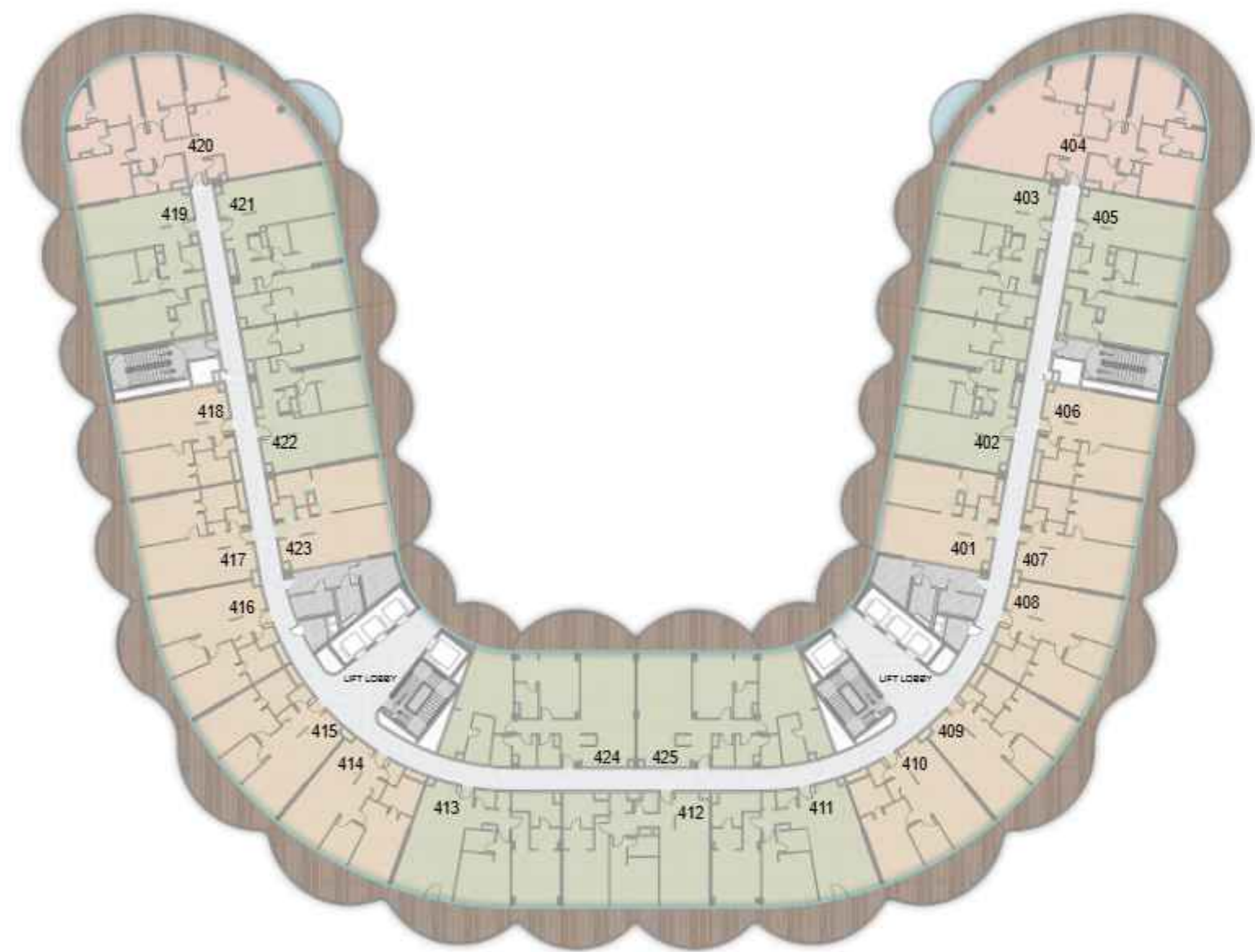

# LEVEL 4

- 1BR UNITS
- 2BR UNITS
- 3BR UNITS

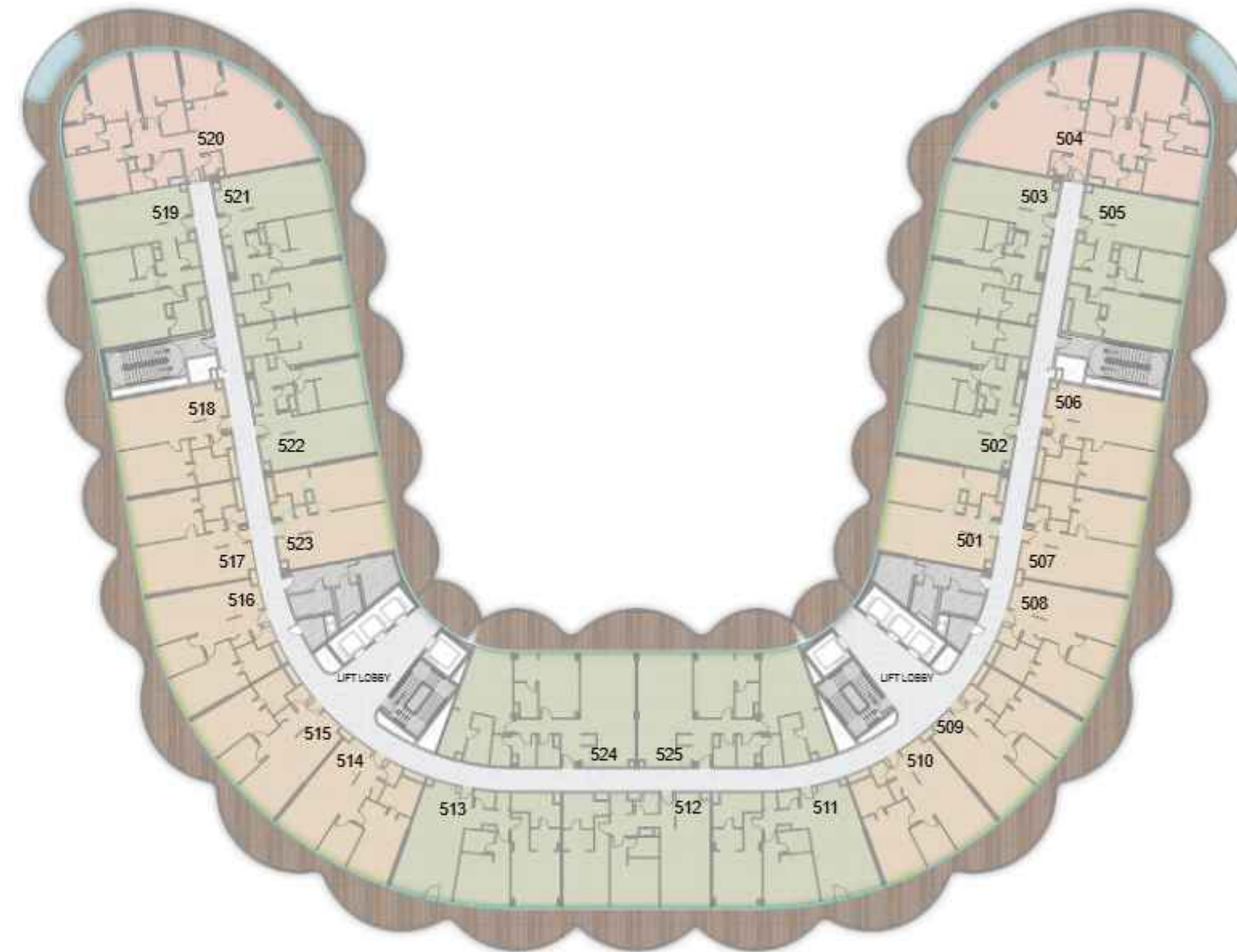

# LEVEL 5

- 1BR UNITS
- 2BR UNITS
- 3BR UNITS



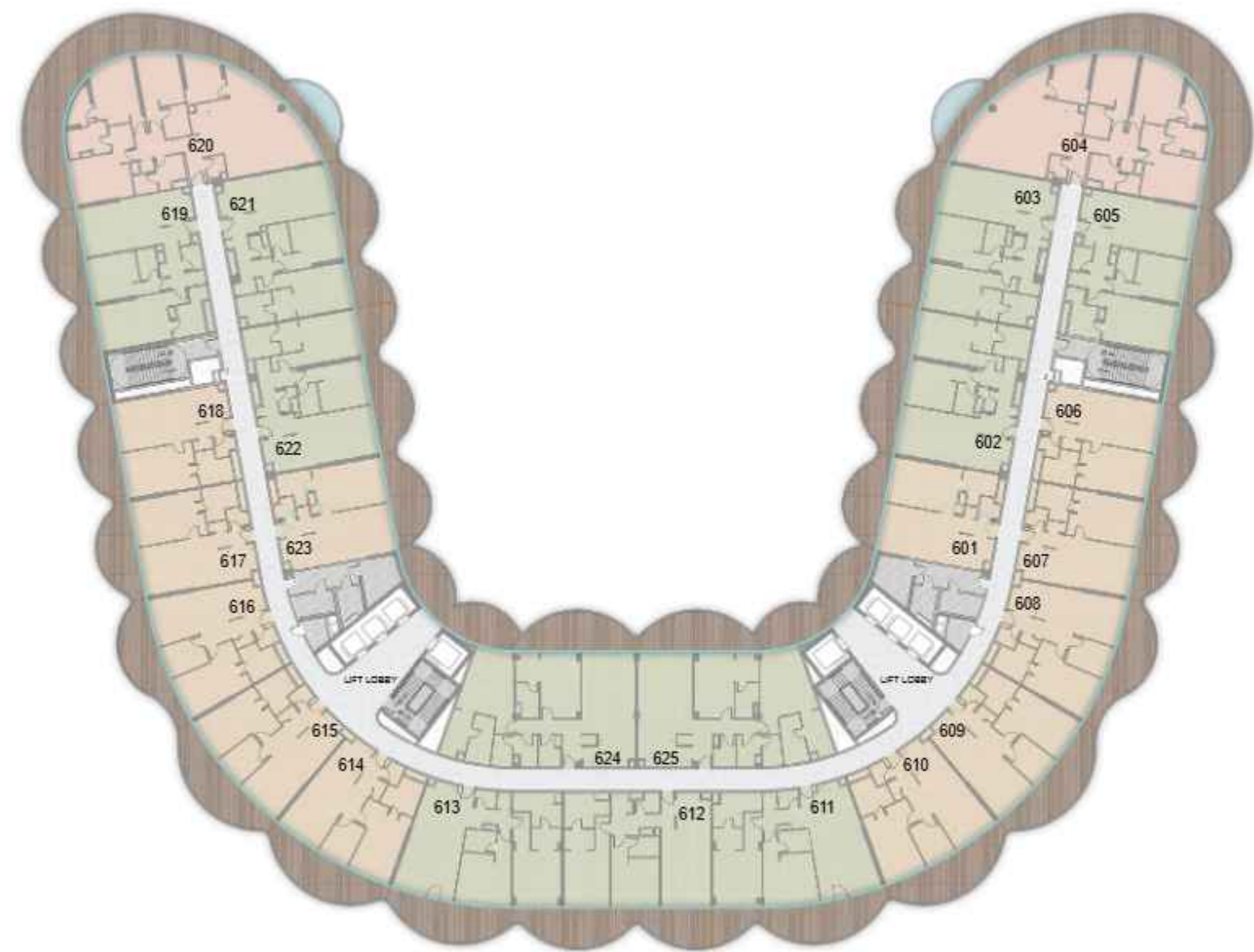

## LEVEL 6

- 1BR UNITS
- 2BR UNITS
- 3BR UNITS

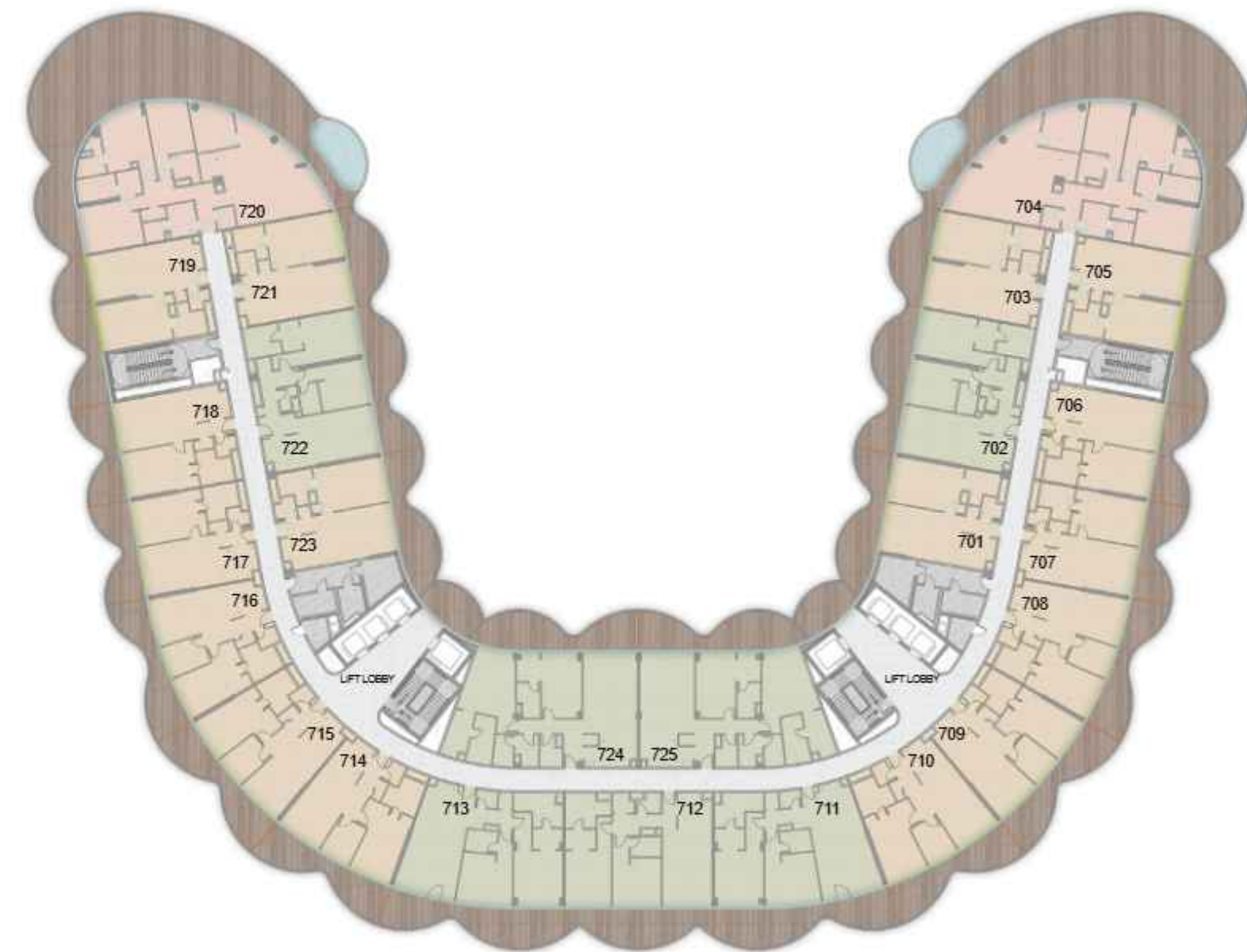

## LEVEL 7

- 1BR UNITS
- 2BR UNITS
- 3BR UNITS



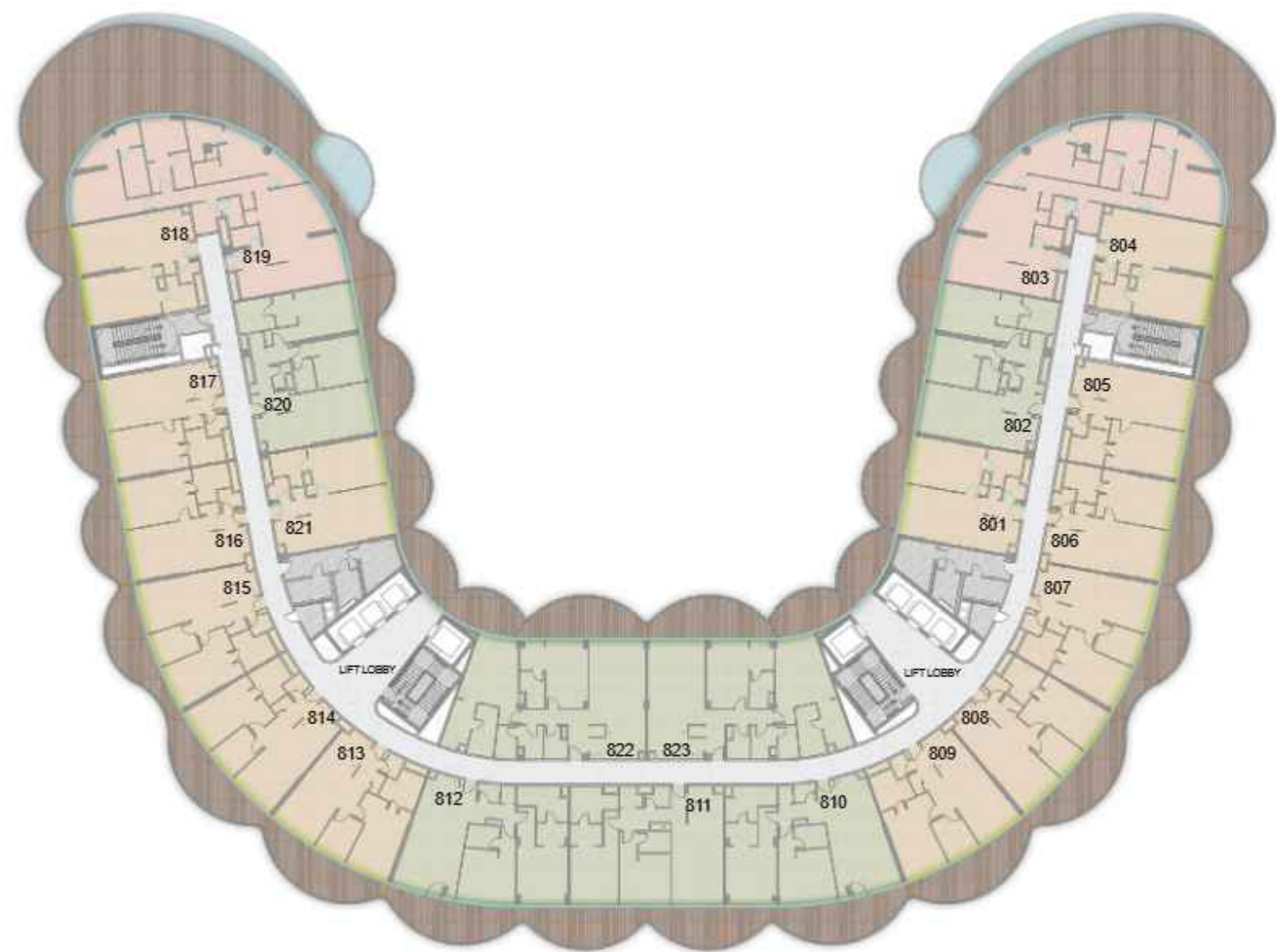

# LEVEL 8

- 1BR UNITS
- 2BR UNITS
- 3BR UNITS

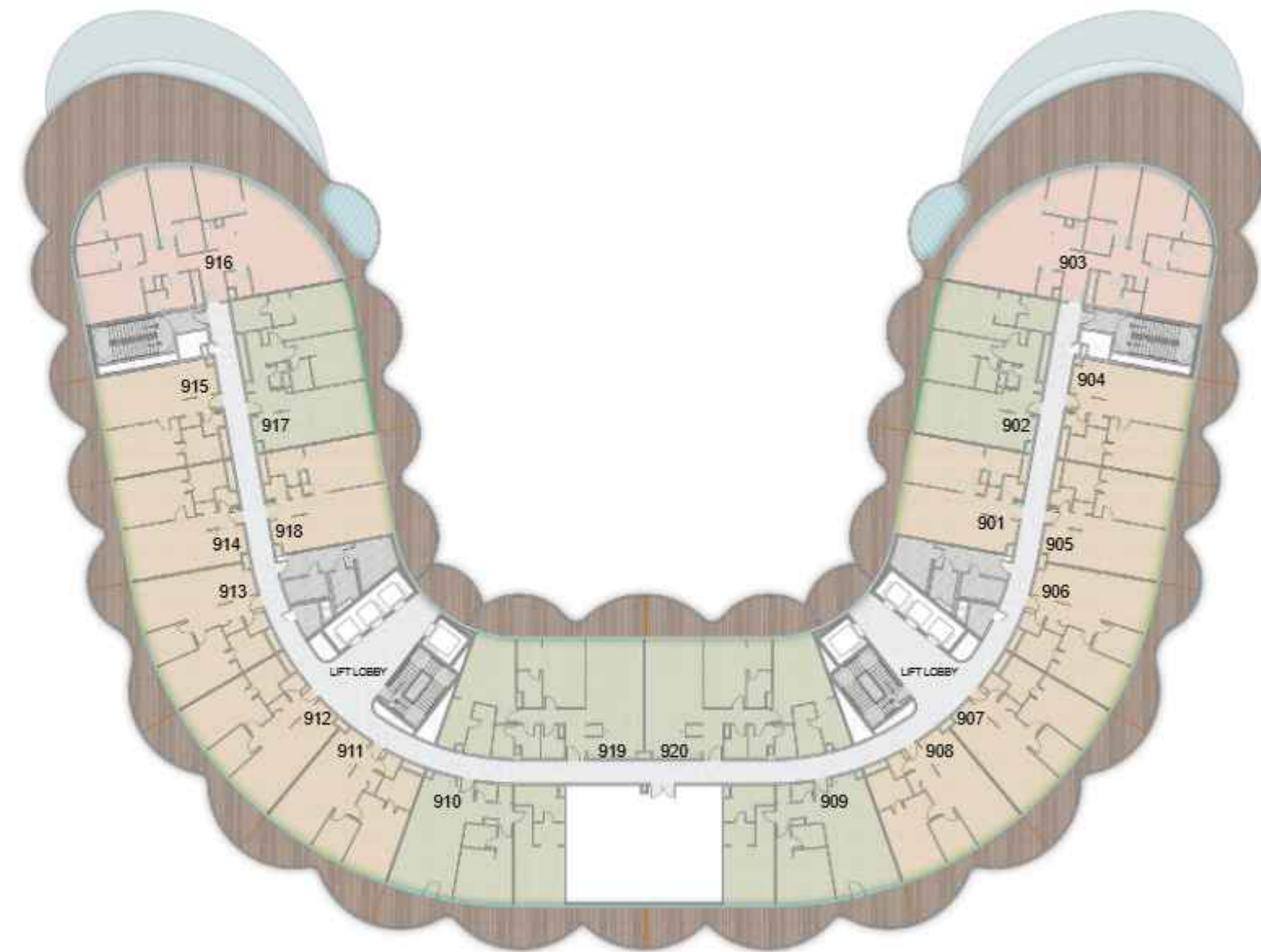

# LEVEL 9

- 1BR UNITS
- 2BR UNITS
- 3BR UNITS



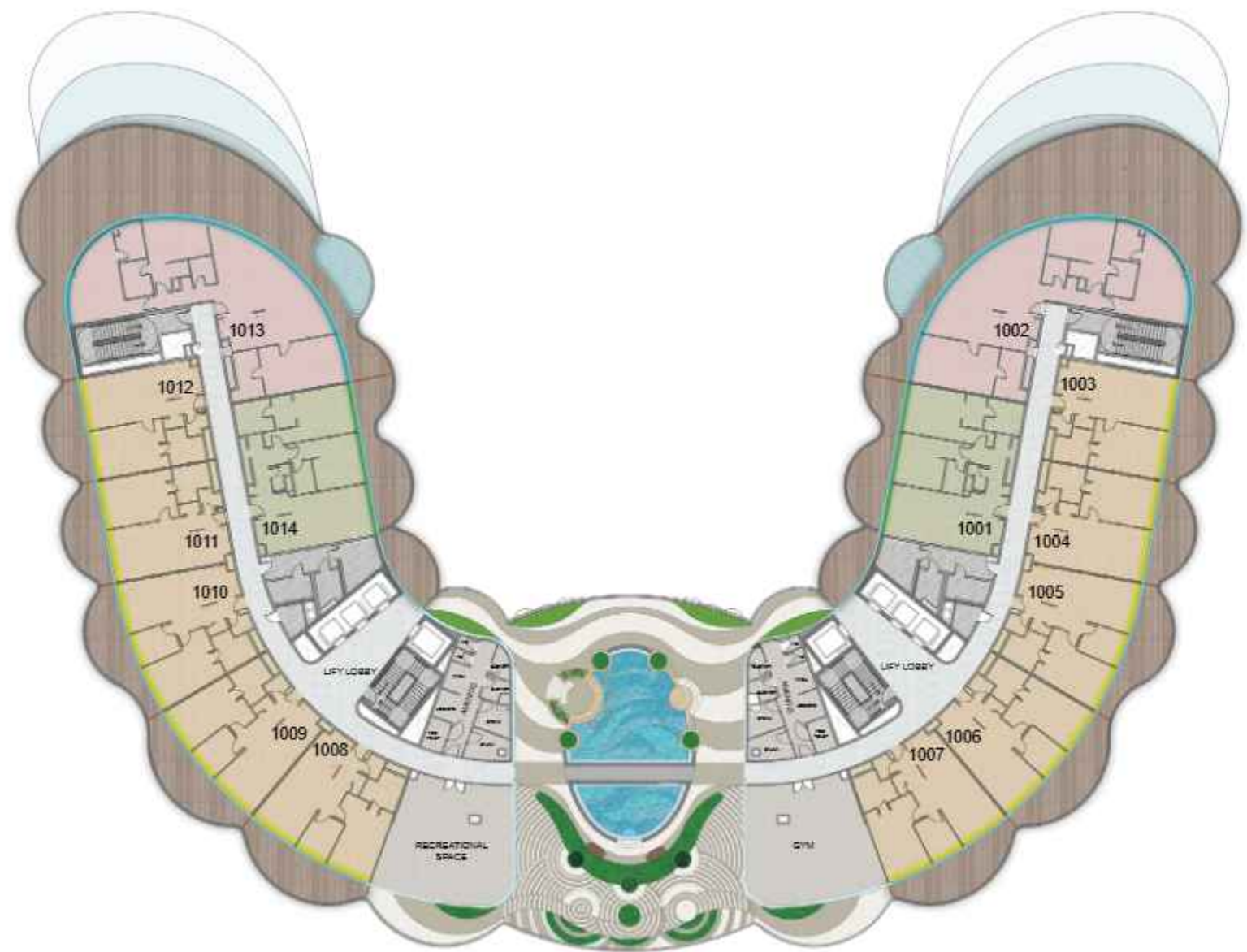

## LEVEL 10

- 1BR UNITS
- 2BR UNITS
- 3BR UNITS

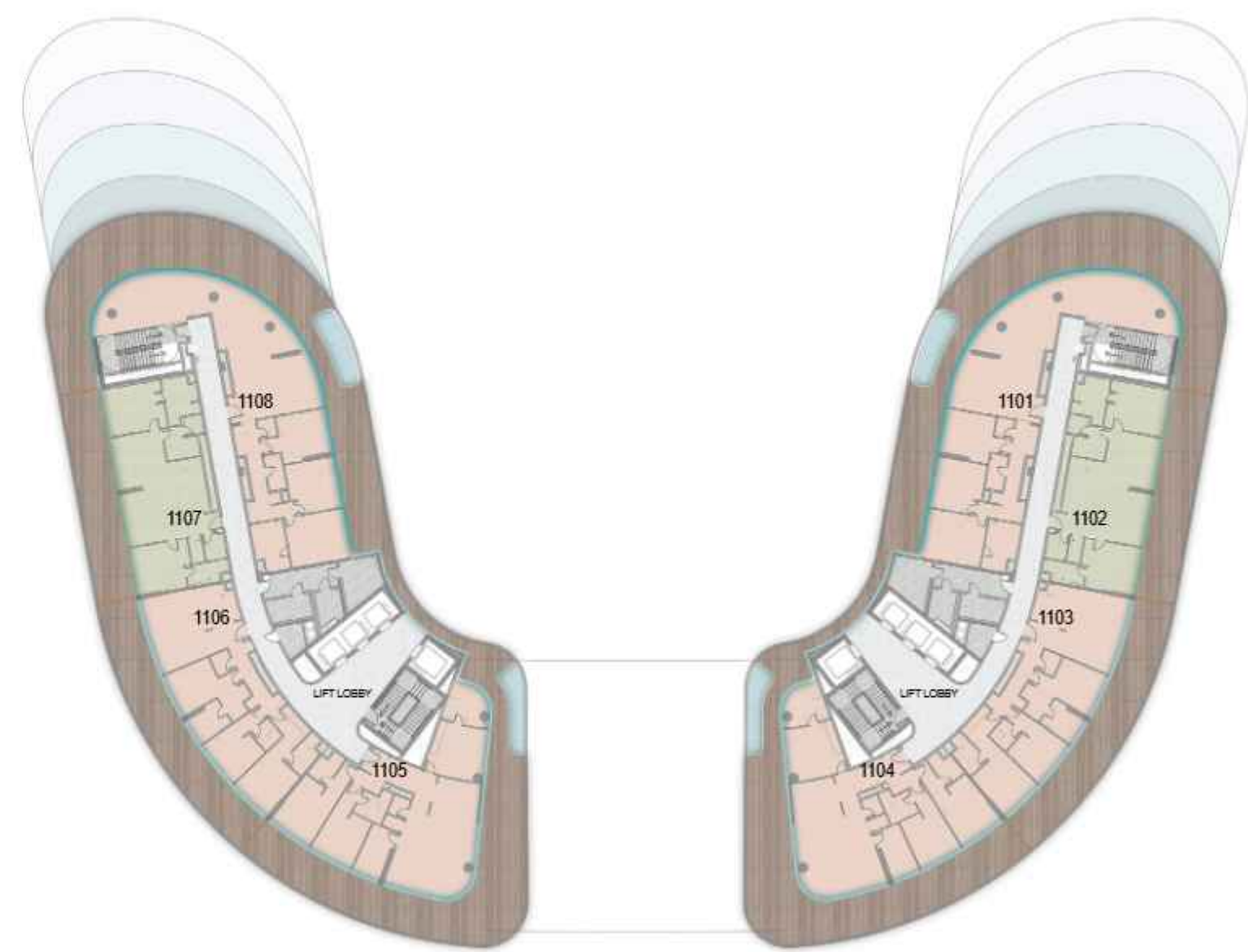

## LEVEL 11

- 1BR UNITS
- 2BR UNITS
- 3BR UNITS





# PENTHOUSES

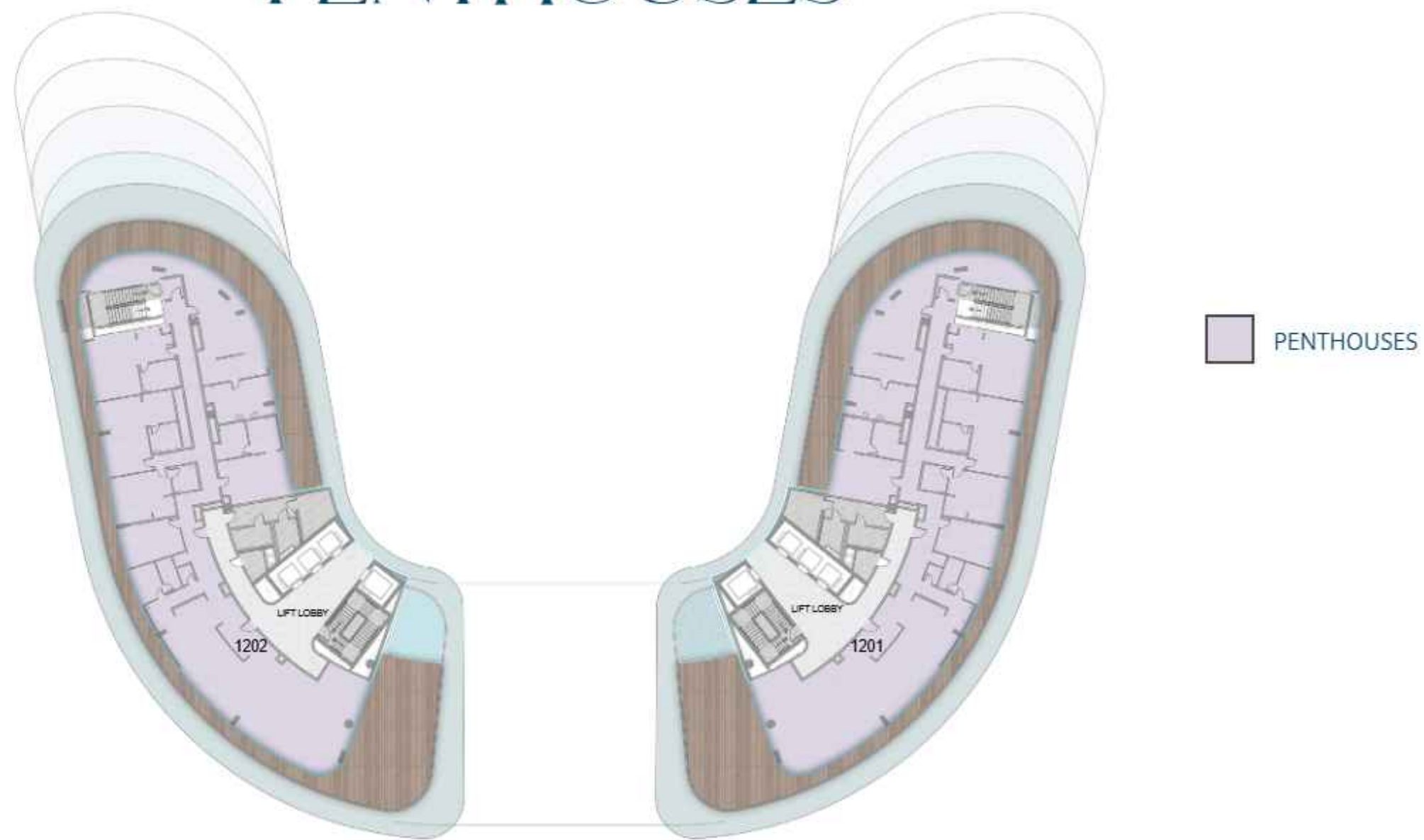









BNW DEVELOPMENTS  
بي ان دبليو للتطوير العقاري

24<sup>th</sup> & 33<sup>rd</sup> Floor, Ubora Tower, Business Bay, Dubai, UAE

☎ 800 BNWUAE 🌐 [www.bnw.ae](http://www.bnw.ae) ✉ [info@bnw.ae](mailto:info@bnw.ae)