

## Dubai, Design District – Penthouse na prodaju



### Cijene i troškovi

Nabavna cijena	Cijena na upit
Umirovljenik	1
Umirovljenik	3

### Podaci o nekretnini

Živi prostor	532,66 m <sup>2</sup>
Ukupna površina	676,13 m <sup>2</sup>
Sobe	7
spava?e sobe	5
Kupaonice	4
Veli?ina balkona/terase	143,47 m <sup>2</sup>
Balkoni	5
Stanje nekretnine	Prvo korištenje
stara/nova zgrada	Nova zgrada
Status prodaje	otvoren

### Zna?ajke

Op?a kategorizacija	Luksuzan
Kupaonica	Tuš

Kuhinja	Ugradbena kuhinja
Vrsta grijanja	Središnji
Klimatizirano	Da
Lift	Osobe
namješteno	potpuno
Kabelska/satelitska TV	Da
Skladištenje	Da
prilagođen starijim osobama	Da

## Opis nekretnine

Ovaj penthouse s pet spavaćih soba u d3 predstavlja luksuz i sofisticiranost. S dvostrukim visinama dnevnog boravka i blagovaonice, dom je idealan za one koji traže prostor i eleganciju. Penthouse ima prostranu privatnu terasu s neusporedivim pogledom na dubajsku panoramu i Creek. Svaka spavaća soba je utočište udobnosti, opremljena velikim ormarima i kupaonicama u spa stilu za potpuno opuštanje. Arhitektura je inspirirana cvijetom pustinje, s elegantnim zakrivljenim linijama i brončanim detaljima koji ispunjavaju interijer diskretnim glamurozitetom. Svaki detalj ove nekretnine, od otvorenog plana do modernih, sofisticiranih završetaka, pažljivo je dizajniran kako bi svakodnevni život pretvorio u iznimno iskustvo. Atélis u d3 primjer je inovacije u kreativnoj četvrti Dubaja. Blizina luksuznih restorana, kulturnih institucija i umjetničkih galerija čini ovaj penthouse idealnim izborom za kreativne profesionalce. Okolica potiče društvene veze s pješčanim stazama, biciklističkim stazama i umjetničkim instalacijama koje stvaraju živahnu atmosferu. Dizajnirao ga je Skidmore, Owings & Merrill (SOM), arhitekti iza Burj Khalife, a Atélis kombinira modernu arhitekturu s principima održivosti. Bilo da uživate u miru uz vodu ili istražujete dinamičan gradski život, ovaj penthouse nudi harmoničnu kombinaciju mira i sofisticiranosti.

## Mjesto

Dubai Design District (d3) je globalno priznato odredište za život, središte kreativnosti, umjetnosti, mode i inovacija. Smješten strateški blizu Dubai Creeka, d3 omogućava jednostavan pristup ikoničnim mjestima kao što su Burj Khalifa, The Dubai Mall, DIFC i Business Bay, čineći ga idealnim za one koji traže dinamičan gradski život. Njegova blizina Ras Al Khor Wildlife Sanctuary nudi fantastičan pogled, dok posvećenost održivom dizajnu i prijateljsstvu prema pješacima stvara jedinstvenu kombinaciju prirode i gradskog života.

## Značajke

Ovaj penthouse u d3 nudi niz ekskluzivnih sadržaja, uključujući i direktan pristup obali, infinity bazen s panoramskim pogledom na grad, slapove i bujne vrtove. Stanari mogu uživati u udobnim sjedalaškim prostorima, kabanama i društvenim salama, savršenim za sastanke. Za obitelji penthouse nudi dječji bazen, dječji klub i multifunkcionalnu sobu. Ljubitelji fitnessa mogu uživati u modernoj teretani, dok coworking prostori i sobe za zabavu povećavaju udobnost. Dizajn također uključuje unutarnji i vanjski prostor s privatnim terasama, vrtovima i tihim vanjskim prostorima koji promiču uzdignuti i miran način života.

## Drugi

Odricanje odgovornosti: Planovi, detalji i orijentacija jedinica uključeni su samo

kao indikacija i mogu se mijenjati od strane developera/prodavca prema vlastitom naho?enju bez prethodne obavijesti i/ili odgovornosti. Sve slike, uklju?uju?i karakteristike, završne obrade, namještaj, pogled i mjerilo, samo su ilustrativne. Kona?ni prostori, orijentacija, dimenzije, raspored i materijali mogu se razlikovati od navedenih.

## Adresa

Building 3, Level 2  
Dubai Design District (d3)

## Dobavlja?

TANAMI PROPERTIES  
Al Marsa Street  
3405 Marina Plaza

Telefon glavni ured

+971 4 248 3400

E-pošta

[office@ihr-makler.cc](mailto:office@ihr-makler.cc)

Web stranica

[victoriacrigan@tanamiproperties.ae](mailto:victoriacrigan@tanamiproperties.ae)



## PENTHOUSE LIVING ABOVE ALL ELSE

The five-bedroom penthouses rise above it all, featuring soaring double-height living and dining spaces, statement staircases, and expansive private terraces. With panoramic views of the Dubai skyline, lush bedrooms, and spa-style bathrooms, every detail is crafted to deliver an exceptional lifestyle.

Generous living and dining areas flow seamlessly onto the private terrace, offering a breathtaking backdrop of the city perfect for elevated everyday living and sophisticated entertaining.

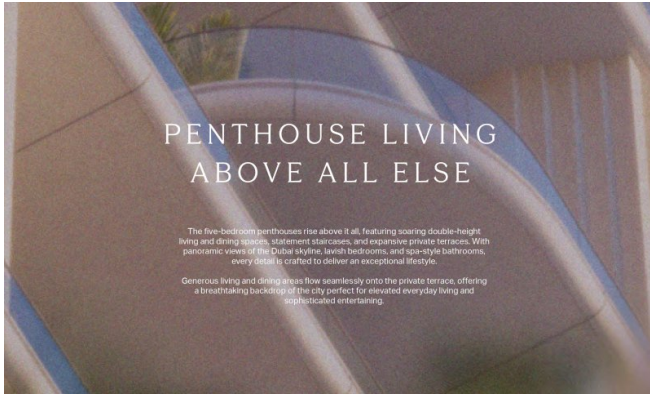



- 6 min • The Dubai Mall
- 7 min • Downtown Dubai
- 7 min • City Walk
- 10 min • Burj Khalifa
- 10 min • Business Bay
- 12 min • DIFC
- 15 min • DXB Airport

## A UNIQUE SKYLINE

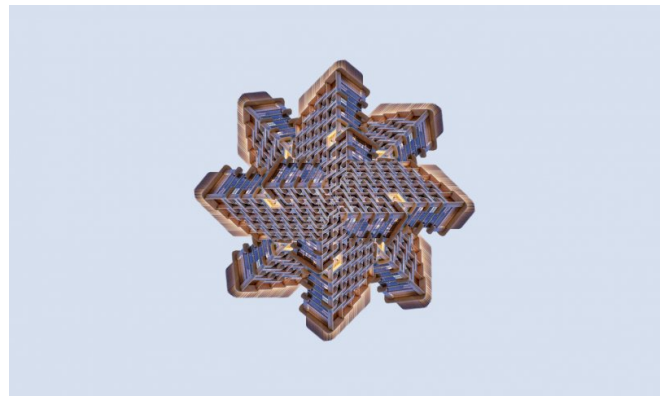

Spanning 13 million square feet, d3 comes together to create a nurturing space where people can



## AN ARTISTIC EXPRESSION OF LIVING



## RIISING ON THE EDGE

Dubai's creative district. This residential waterfront icon reflects the spirit of d3, where forward-thinking design, environmental awareness, and purposeful innovation come together. With uninterrupted views of the water, Atélis at d3 offers a serene contrast to the energy of the city, bringing residents closer to nature while staying connected to creativity and culture.



## ROOTED IN IMAGINATION

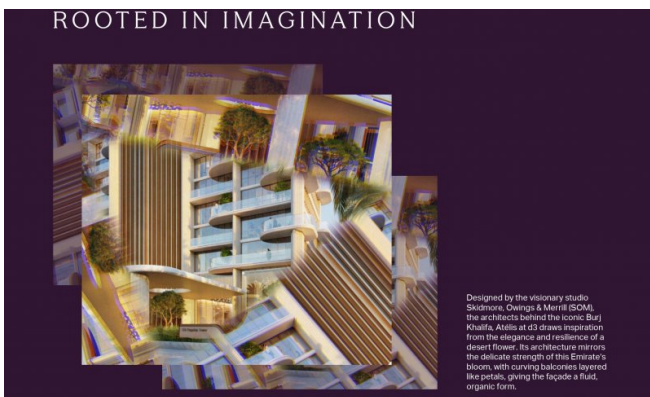

Designed by the visionary studio Skidmore, Owings & Merrill (SOM), the architects behind the iconic Burj Khalifa, Atélis at d3 draws inspiration from the elegance and resilience of a desert flower. Its architecture mirrors the delicate strength of the Emirates bloom, with curving balconies layered like petals, giving the façade a fluid, organic form.

## SOM: THE ARCHITECTS OF TOMORROW'S ICONS



As global pioneers in architecture, engineering, and planning, SOM is renowned for shaping cities through sustainable innovation and bold boundary-pushing. Atélis at d3 is a testament to their commitment to creating iconic, sustainable living environments.

SIGNATURE  
EXPERIENCES  
AT EVERY  
LEVEL



The first level includes a well-appointed gym overlooking the gardens. Layered outdoor spaces throughout the building immerse residents in nature while echoing the creative pulse of d3. From shimmering water features and shaded walkways to calming green zones, every detail is designed to foster well-being, leisure, and a seamless connection between architecture, landscape, and



Higher up, an infinity pool and tranquil garden spaces offer residents a place for reflection and restoration, promoting both mental and physical well-being. With panoramic views of the Dubai skyline, the elevated wellness level invites residents to unwind in



**KEY FEATURES**



- Grand statement arrival framed by nature
- Direct access to the waterfront
- Cascading swimming pool
- Infinity pool with skyline views
- Each house accessible without
- Dedicated kids' pool
- Sunken seating and cabanas
- Social lounges for gatherings
- Entertainment room
- Fully air-conditioned rooms
- Garden spaces and meditative zones
- Outdoor co-working areas
- Indoor kids' club and learning area
- Outdoor kids' play area
- Multi-functional spaces



THE ART OF  
SUBTLETY

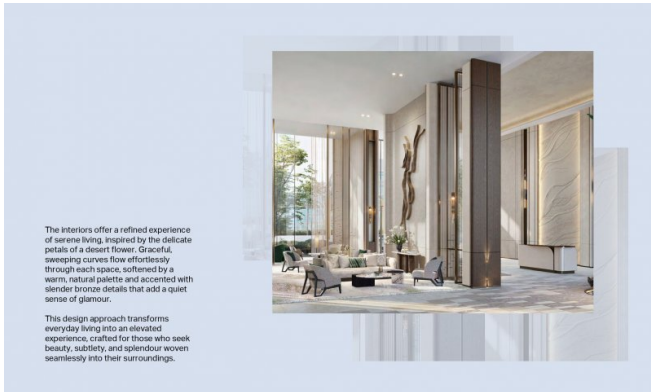

The interiors offer a refined experience of serene living, inspired by the delicate petals of a desert flower. Graceful, sweeping curves flow effortlessly through each space, softened by a warm, natural palette and accented with slender bronze details that add a quiet sense of glamour.

This design approach transforms everyday living into an elevated experience, crafted for those who seek beauty, subtlety, and splendour woven seamlessly into their surroundings.



**RESIDENCES FRAMED BY VIEWS**

Each one- to four-bedroom residence is a benchmark in contemporary elegance and comfort. Flowing, open-plan interiors are complemented by exquisitely finished kitchens and expansive bedrooms, designed to elevate daily living.

Generously sized bedrooms offer a perfect blend of comfort and sophistication, with ample space for built-in closets that merge both convenience and style. Private balconies frame sweeping panoramic views of the Dubai skyline, creating a connection between indoor serenity and the world beyond.

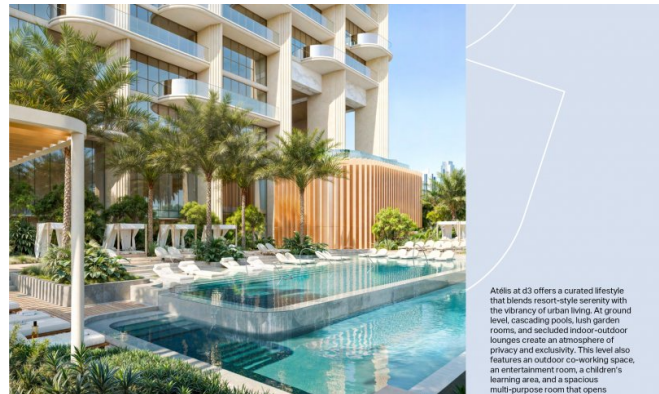

Atells at d3 offers a curated lifestyle that blends resort-style serenity with the vibrancy of urban living. At ground level, cascading pools, lush garden rooms, and secluded indoor-outdoor lounges create an atmosphere of privacy and exclusivity. This level also features an outdoor co-working space, an entertainment room, a children's learning area, and a spacious multi-purpose room that opens

