

2 BR B1-N1 Dubai, Emirates Towers – Ultra luksuzne rezidencije s uslugama

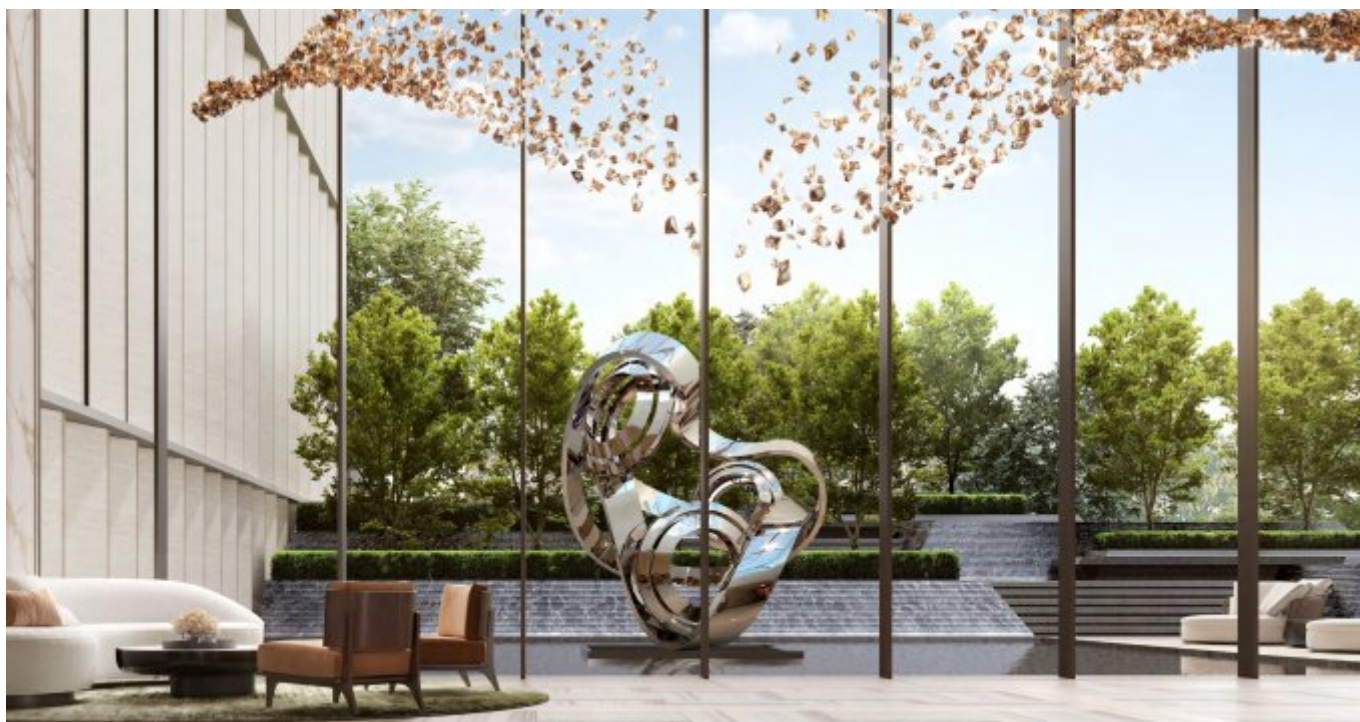

Cijene i troškovi

Nabavna cijena	Cijena na upit
----------------	----------------

Podaci o nekretnini

Živi prostor	103,64 m ²
Ukupna površina	103,64 m ²
Sobe	4
spava?e sobe	1
Kupaonice	2
Stanje nekretnine	Prvo korištenje
stara/nova zgrada	Nova zgrada
Status prodaje	otvoren

Zna?ajke

Op?a kategorizacija	Luksuzan
Kupaonica	Tuš, Kada
Kuhinja	Ugradbena kuhinja, Otvoren
Vrsta grijanja	Središnji
Klimatizirano	Da
Lift	Osobe

namješteno	potpuno
Kabelska/satelitska TV	Da
Sigurnosne značajke	Fotoaparati
Skladištenje	Da
prilagođen starijim osobama	Da

Opis nekretnine

Rezidencije imaju profinjen dizajn s otvorenim rasporedom koji potiče osjećaj jasnoće i udobnosti. Svaki dom opremljen je vrhunskim kuhinjama, nadopunjen luksuznim završnim obradama i integriranim uređajima. Prostrani dnevni prostori glatko se povezuju, nudeći sofisticiranu, ali toplu atmosferu s karamel tonovima, vrhunskim mramorom i završnim obradama od prirodnog drva. Svaka rezidencija dizajnirana je da uravnoteži funkcionalnost i stil, nudeći mirno utočište s zadivljujućim pogledom na gradsku panoramu. Kule su arhitektonska remek-djela, podignute na gotovo nevidljivim stupovima kako bi pružile panoramski pogled od centra Dubaija do otvorenog mora, uz potpunu privatnost za svakog stanovnika.

Doživljaj dolaska je veličanstven, s dvostruko visokom predvorjem, mirnim vrtnim dvorištem i elegantnim salonima. Nebeske terase na vrhu podižu svakodnevni život luksuznim beskonačnim bazenom, panoramskim vrtnim salonima i prostranim otvorenim prostorima za događanja. Personalizirane usluge, uključujući spa tretmane, osobne trenere, pomoć vratara i privatne opcije blagovanja, osiguravaju životni stil definiran luksuzom i udobnošću. Svaki je detalj osmišljen kako bi pružio besprijekorno životno iskustvo koje spaja kulturni dizajn s profinjenom udobnošću.

Mjesto

Nalaze se u srcu globalnog poslovnog središta Dubaija, s jednostavnim pristupom Sheikh Zayed Road i Al Khail Road. U blizini su City Walk, Downtown Dubai, plaža J1 i kulturne znamenitosti poput Muzeja budućnosti i DIFC-a. Ova dinamična četvrt dom je međunarodnim institucijama, vrhunskim restoranima i prestižnim galerijama, pružajući neusporediv način života gdje se posao, kultura i zabava skladno spajaju.

Značajke

Stanari imaju ekskluzivan pristup sky poolovima, infinity bazenima samo za odrasle, panoramskim vrtovima i privatnim terasama za događaje iznad grada. Spa centar, potpuno opremljena teretana, studiji za jogu i spinning, wellness klub sa saunom i salon za nokte pružaju brojne mogućnosti za relaksaciju. Također, tu su privatne blagovaonice, brendirani restoran, coworking prostori, privatno kino, dječja igrališta, paddle tereni i multifunkcionalni prostori za događaje.

Drugi

Odricanje odgovornosti: Planovi, detalji i orijentacija jedinica uključeni su samo kao indikacija i mogu se mijenjati od strane developera/prodavca prema vlastitom nahođenju bez prethodne obavijesti i/ili odgovornosti. Sve slike, uključujući karakteristike, završne obrade, namještaj, pogled i mjerilo, samo su ilustrativne. Konačni prostori, orijentacija, dimenzije, raspored i materijali mogu se razlikovati od navedenih.

Adresa

Emirates Tower

Dobavlja?

TANAMI PROPERTIES
Al Marsa Street
3405 Marina Plaza

Telefon glavni ured
E-pošta
Web stranica

+971 4 248 3400
office@ihr-makler.cc
victoriacrigan@tanamiproperties.ae

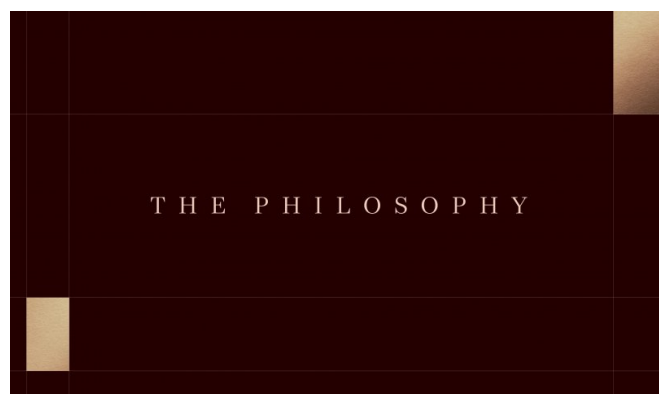
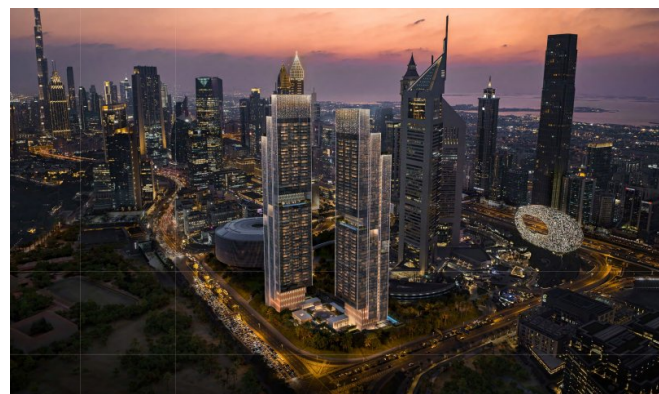
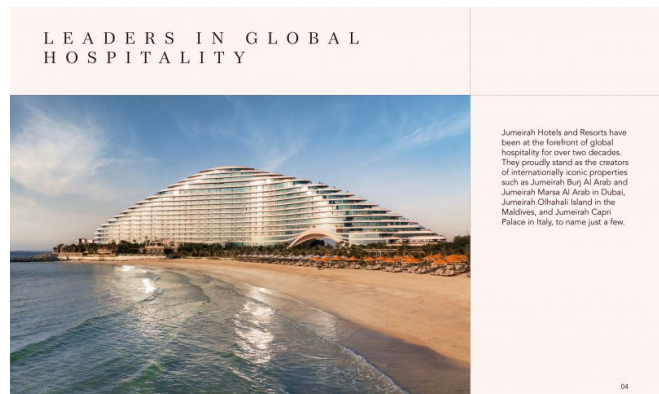

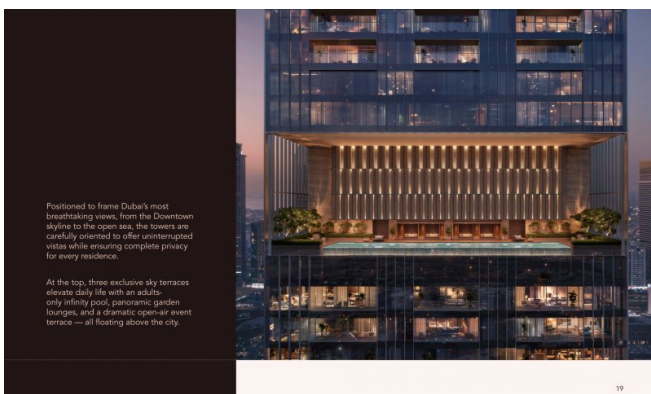
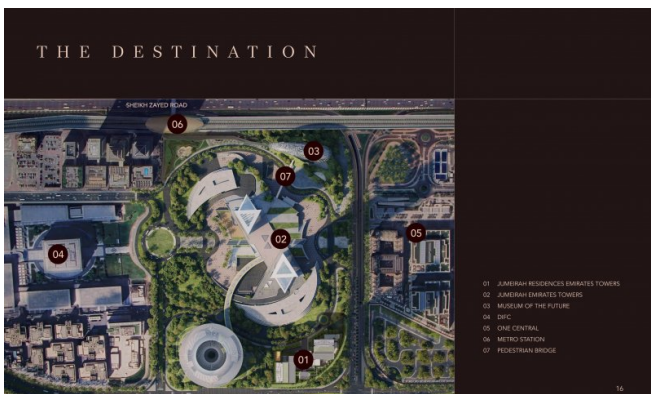
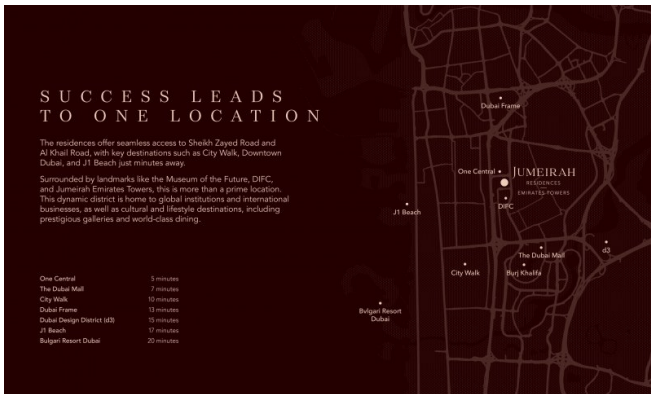
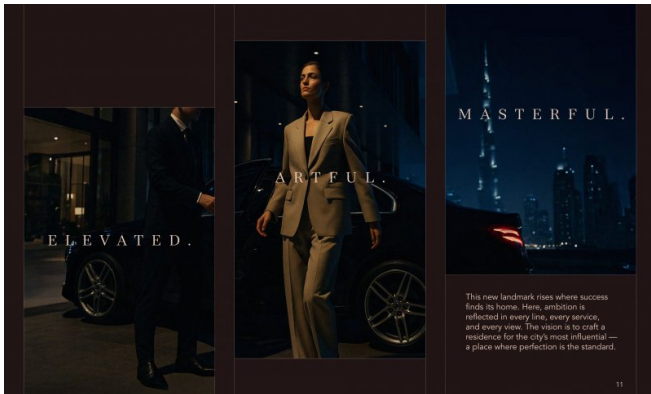

A PALETTE COMPOSED FOR ELEGANCE

A thoughtfully curated palette defines each space with quiet sophistication. The exterior design evokes warmth, with caramel-toned accents, premium marble, and understated wood finishes adding depth and subtle richness. Clean lines shape the architectural flow, while fluted glass details introduce a sense of lightness and texture. A tone-on-tone foundation, grounded by a refined mix of stone and timber, creates a perfect balance.

WHERE EVERY NEED IS ANTICIPATED

From personalised spa treatments to private dining and concierge, every service is tailored to match your pace. This is a lifestyle of seamless efficiency, where daily details are expertly managed, freeing you to focus on what matters most.

23

BASIC SERVICES

- 24/7 Security
- Concierge
- Public Area Maintenance
- Public Area Cleaning
- Lounge/Pool Attendants
- Door/Valet
- Lifeguards

À LA CARTE SERVICES

STANDARD SERVICES	SPA & FITNESS SERVICES
<ul style="list-style-type: none"> Laundry Housekeeping Childcare Car Care Maintenance/Engineering Services 	<ul style="list-style-type: none"> Groceries Service Party Service Transportation <p>A wide selection of Jumeirah rejuvenating SPA treatments and massages can be booked with a Jumeirah SPA therapist.</p> <ul style="list-style-type: none"> Hair-dressing services can be offered at the salon or at the residence. Personal trainer is available upon request to deliver an individual training and/or meal plan and control training sessions.

PRIVATE CHEF & EVENTS

- Jumeirah renowned chefs at a private meal service
- Personalised event planning

24

DESIRED BY MANY. RESERVED FOR FEW.

Experiences are thoughtfully tiered across two levels, from the garden level and onward to the sky, bringing together purposeful living with refined comfort.

25

<ul style="list-style-type: none"> 01 ENTRANCE 02 ARRIVAL TOWER LOBBY LOUNGE 03 CAR PARK ACCESS 04 RESTAURANT 05 MIDDLE COURT 06 ADULTS POOL 07 KIDS POOL 08 SOCIAL HALL 09 MULTI-PURPOSE SPACE 10 DINING EVENT 11 OPEN KITCHEN EVENT 12 PLAYGROUND 13 SPLASH PLAYGROUND 14 PET LAWN 15 BACKCOURT HOUSE ACCESS 16 POWDER ROOM 	
---	--

26

ARRIVAL

Sheltered beneath a striking cantilever, the arrival zone offers a grand, warm welcome. The private entrance sets a calm, refined tone where the architecture appears to float and time seems to pause.

27

