

Dubai, Design District Penthouse for Sale



Prices & Costs

Purchase Price	Price on request
Free places	1
underground parking garages	3

Details of the property

Living space	434,11 m ²
Total area	580,91 m ²
Rooms	7
Bedrooms	5
Bathrooms	4
Size of balcony/terrace	146,80 m ²
Balconies	3
Condition of the property	First time use
old/new building	New building
Sale status	open

Features

General categorization	Luxurious
Bathroom	Shower
Kitchen	Fitted kitchen

Kind of heating	Central
Air-conditioned	Yes
Elevator	Persons
furnished	fully
Cable / Satellite TV	Yes
Storage	Yes
senior-friendly	Yes

Property description

This five-bedroom penthouse at d3 epitomizes luxury and sophistication. Designed with soaring double-height living and dining spaces, the home is ideal for those seeking space and elegance. The penthouse features an expansive private terrace that provides unparalleled views of the Dubai skyline and the creek. Each bedroom is a sanctuary of comfort, equipped with generous closet space and spa-style bathrooms for ultimate relaxation. The architecture is inspired by a desert flower, with graceful curves and bronze accents that infuse the interiors with quiet glamour. Every detail of this residence, from the spacious open-plan layout to the sleek, contemporary finishes, has been meticulously designed to elevate daily living into an extraordinary experience.

Atélis at d3 stands as a beacon of innovation in Dubai's creative district. The penthouse's proximity to high-end restaurants, cultural spaces, and art galleries makes it a prime choice for creative professionals. The surrounding district fosters community connections, with promenades, cycling paths, and curated art installations providing residents with a vibrant lifestyle. Designed by Skidmore, Owings & Merrill (SOM), renowned for creating iconic structures like the Burj Khalifa, Atélis integrates cutting-edge architecture with sustainability. Whether enjoying the tranquility of the waterfront or exploring the dynamic city life, this penthouse offers a seamless blend of serenity and sophistication.

Location

Dubai Design District (d3) is a globally renowned lifestyle destination, a hub for creativity, art, fashion, and innovation. Strategically situated near Dubai Creek, d3 boasts easy access to the iconic Burj Khalifa, The Dubai Mall, DIFC, and Business Bay, making it a prime location for those seeking vibrant urban living. The district's proximity to Ras Al Khor Wildlife Sanctuary offers stunning views, while its commitment to sustainable design and walkability ensures a unique balance of nature and city life.

Features

This penthouse in d3 offers an array of exclusive amenities, including direct access to the waterfront, an infinity pool with panoramic city views, cascading swimming pools, and luxurious garden spaces. Residents enjoy the luxury of sunken seating areas, cabanas, and social lounges perfect for gatherings. For families, the penthouse provides a dedicated kids' pool, a kids' club, and a multi-purpose room. Fitness enthusiasts can enjoy a state-of-the-art gym, while co-working spaces and entertainment rooms enhance convenience. The design also incorporates indoor-outdoor living, with private terraces, garden lounges, and tranquil outdoor spaces, fostering an elevated and serene lifestyle.

Others

Disclaimer: plans, details and unit orientation included are indicative only and are subject to change by the developer/seller at its sole discretion without notice and/or liability. All images, including features, finishes, furnishings, view and scale are illustrative only. Final areas, orientation, dimensions, layout and materials may differ from those stated.

Address

d3 dubai design district 1

Vendor

TANAMI PROPERTIES
Al Marsa Street
3405 Marina Plaza

Telephone main office

+971 4 248 3400

E-Mail

office@ihr-makler.cc

Website

victoriacrigan@tanamiproperties.ae



PENTHOUSE LIVING ABOVE ALL ELSE

The five-bedroom penthouses rise above it all, featuring soaring double-height living and dining spaces, statement staircases, and expansive private terraces. With panoramic views of the Dubai skyline, lush bedrooms, and spa-style bathrooms, every detail is crafted to deliver an exceptional lifestyle.

Generous living and dining areas flow seamlessly onto the private terrace, offering a breathtaking backdrop of the city perfect for elevated everyday living and sophisticated entertaining.

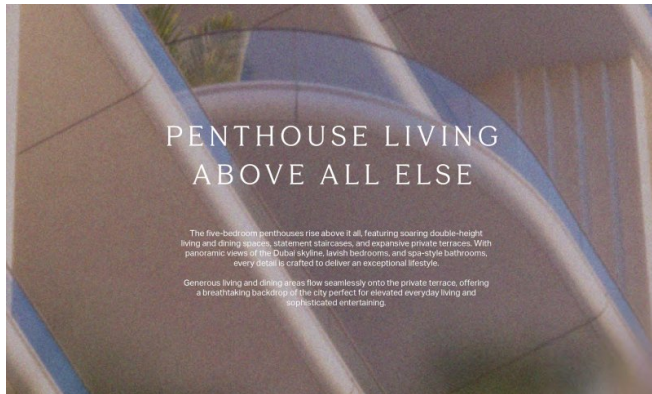
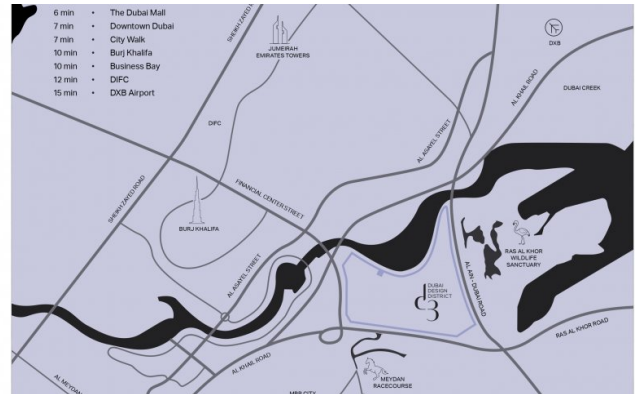



- 6 min • The Dubai Mall
- 7 min • Downtown Dubai
- 7 min • City Walk
- 10 min • Burj Khalifa
- 10 min • Business Bay
- 12 min • DIFC
- 15 min • DXB Airport

A UNIQUE SKYLINE

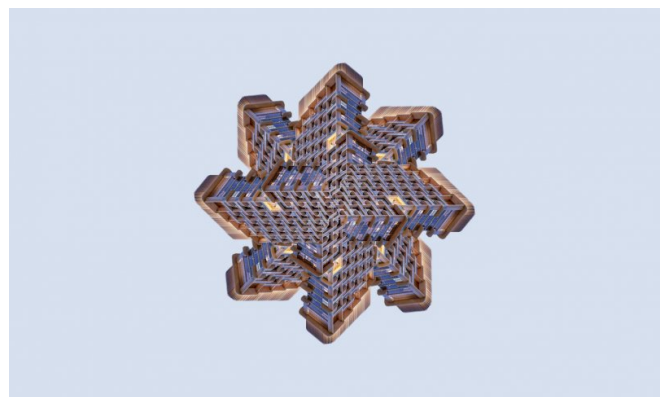

Spanning 13 million square feet, d3 comes together to create a nurturing space where people can



AN ARTISTIC EXPRESSION OF LIVING



RIISING ON THE EDGE

Dubai's creative district. This residential waterfront icon reflects the spirit of d3, where forward-thinking design, environmental awareness, and purposeful innovation come together. With uninterrupted views of the water, Atélis at d3 offers a serene contrast to the energy of the city, bringing residents closer to nature while staying connected to creativity and culture.



ROOTED IN IMAGINATION

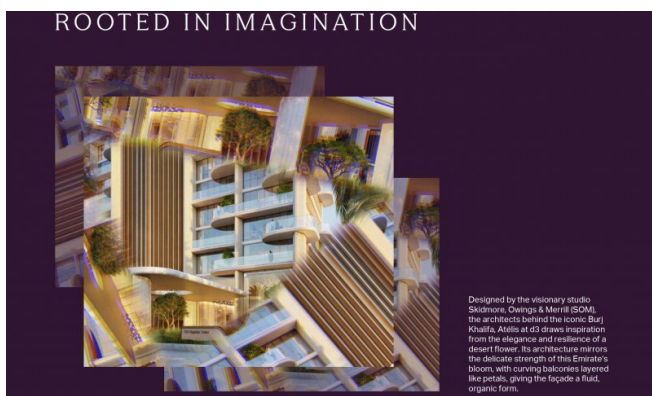

Designed by the visionary studio Skidmore, Owings & Merrill (SOM), the architects behind the iconic Burj Khalifa, Atélis at d3 draws inspiration from the elegance and resilience of a desert flower. Its architecture mirrors the delicate strength of the Emirates bloom, with curving balconies layered like petals, giving the façade a fluid, organic form.

SOM: THE ARCHITECTS OF TOMORROW'S ICONS



As global pioneers in architecture, engineering, and planning, SOM is renowned for shaping cities through sustainable innovation and bold, boundary-pushing design. From iconic skyscrapers to urban planning, SOM's expertise is at the heart of the world's most remarkable buildings and cities.

SIGNATURE
EXPERIENCES
AT EVERY
LEVEL



The first level includes a well-appointed gym overlooking the gardens. Layered outdoor spaces throughout the building immerse residents in nature while echoing the creative pulse of d3. From shimmering water features and shaded walkways to calming green zones, every detail is designed to foster well-being, leisure, and a seamless connection between architecture, landscape, and



Higher up, an infinity pool and tranquil garden spaces offer residents a place for reflection and restoration, promoting both mental and physical well-being. With panoramic views of the Dubai skyline, the elevated wellness level invites residents to unwind in



KEY FEATURES



- Grand statement arrival framed by nature
- Direct access to the waterfront
- Cascading swimming pool
- Infinity pool with skyline views
- Full access wheelchair access
- Dedicated kids' pool
- Sunken seating and cabanas
- Social lounges for gatherings
- Entertainment room
- Fully air-conditioned rooms
- Garden spaces and meditative zones
- Outdoor co-working areas
- Indoor kids' club and learning area
- Outdoor kids' play area
- Multi-functional spaces



THE ART OF
SUBTLETY

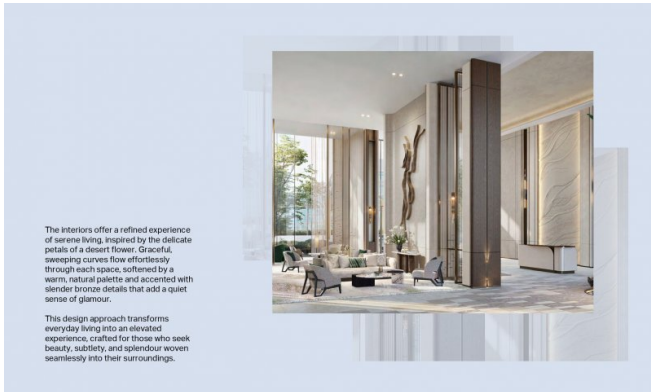

The interiors offer a refined experience of serene living, inspired by the delicate petals of a desert flower. Graceful, sweeping curves flow effortlessly through each space, softened by a warm, natural palette and accented with slender bronze details that add a quiet sense of glamour.

This design approach transforms everyday living into an elevated experience, crafted for those who seek beauty, subtlety, and splendour woven seamlessly into their surroundings.



RESIDENCES FRAMED
BY VIEWS

Each one- to four-bedroom residence is a benchmark in contemporary elegance and comfort. Flowing, open-plan interiors are complemented by exquisitely finished kitchens and expansive bathrooms, designed to elevate daily living.

Generously sized bedrooms offer a perfect blend of comfort and sophistication, with ample space for built-in closets that merge both convenience and style. Private balconies frame sweeping panoramic views of the Dubai skyline, creating a connection between indoor serenity and the world beyond.

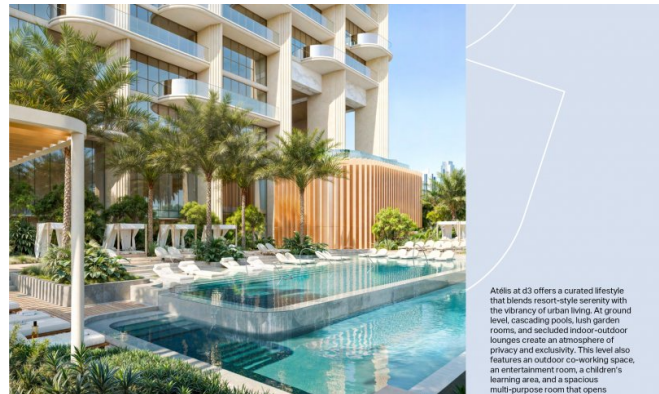

Atells at d3 offers a curated lifestyle that blends resort-style serenity with the vibrancy of urban living. At ground level, cascading pools, lush garden rooms, and secluded indoor-outdoor lounges create an atmosphere of privacy and exclusivity. This level also features an outdoor co-working space, an entertainment room, a children's learning area, and a spacious multi-purpose room that opens

